

Set Up Console

- 7 Turn on console**
Press the power button—a green light will come on.

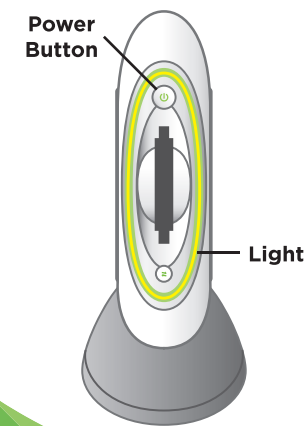

- 8 Turn on your TV**
Use your TV remote to select the correct input/source. You should see the LeapTV startup screen.



Need help? Go to www.leapfrog.com/support/leaptv

Clear Play Area

- 9 Clear objects**
Clear a play area 3-6 feet/1-2 meters from TV. Make sure the play area allows your child to move freely and safely.

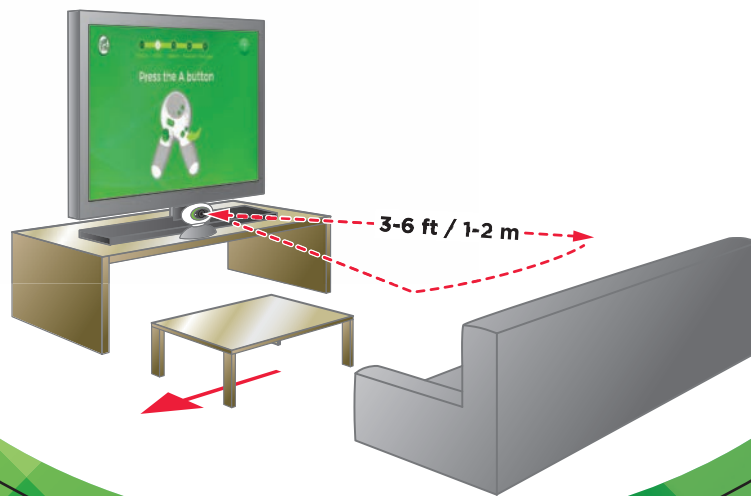

Need help? Go to www.leapfrog.com/support/leaptv

On-Screen Guided Setup

- 10 Complete setup**
Follow the on-screen instructions to complete system setup.



- 11 Register**
To complete parent account setup, go to: leapfrog.com/leaptv/register



Need help? Go to www.leapfrog.com/support/leaptv

Get To Know Your System

- Insert/remove cartridges**
Simply push in/pull out gently.



- Using the controller**
Hold down the transform button and pull the handles apart to switch modes.

Transform Button

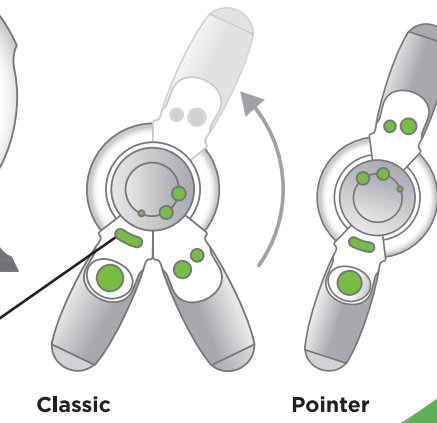

Classic

Pointer

Need help? Go to www.leapfrog.com/support/leaptv

LeapTV™

Educational, Active Video Gaming

Guided Setup for Parents

See LeapTV Parent Guide for complete Operating and Safety Instructions prior to setup and use.

What's Included

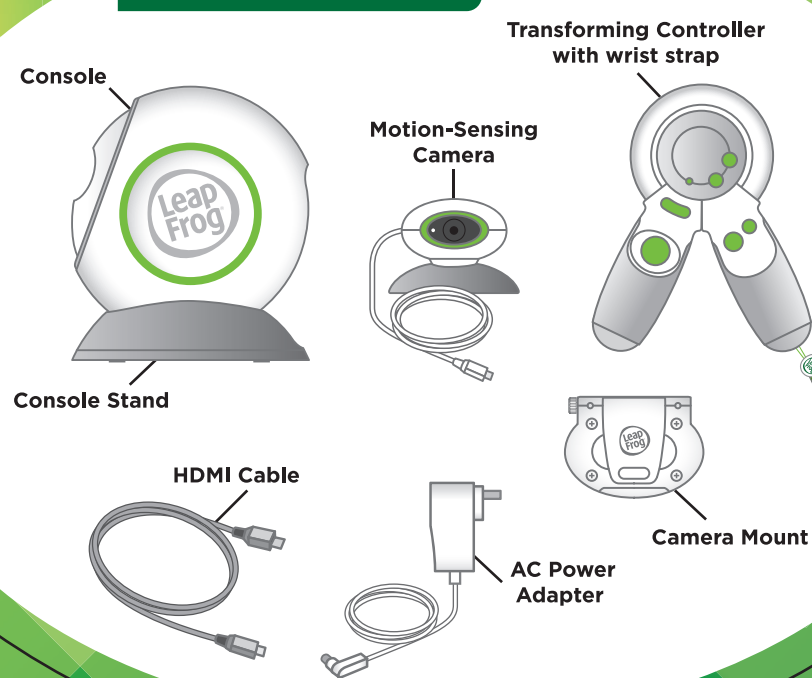

Need help? Go to www.leapfrog.com/support/leaptv

Set Up Transforming Controller

- 1 Power the controller**
Insert two AA batteries (not included) into the back of the controller.

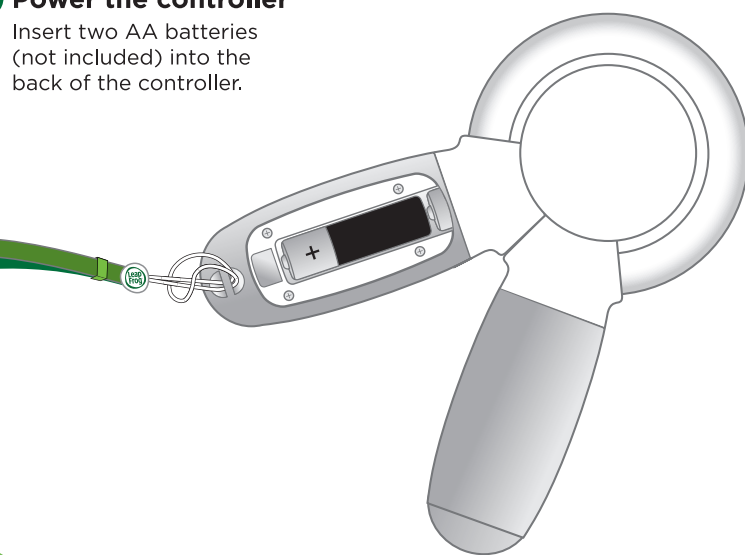

Need help? Go to www.leapfrog.com/support/leaptv

Connect Your System

- 2 Connect to power source**
Plug one end of the AC power adapter into the back of the console, and the other end into a wall outlet or surge protector.

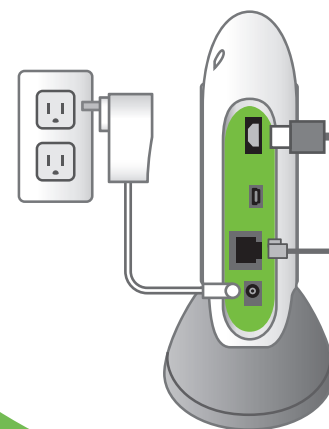

Need help? Go to www.leapfrog.com/support/leaptv

- 3 Connect to your TV**
Use the HDMI cable to connect the console to your TV.



- 4 Connect to Internet**
Wireless: Complete on-screen instructions later (step 11).
-OR-
Wired: Connect the console to your router with an Ethernet cable (not included).



Need help? Go to www.leapfrog.com/support/leaptv

- 5 Connect camera**
Plug camera cord into the USB port on the back of the console.

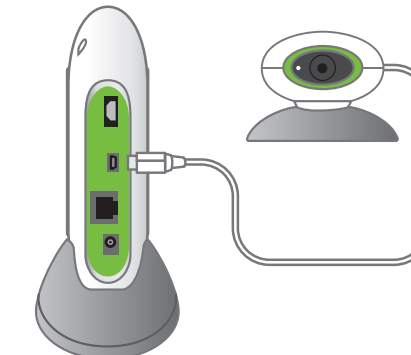

- 6 Flat Surface (recommended):**
Set camera on a flat surface, centered / centred below TV.



- TV Mount (alternate):**
Slide camera base into included mount and attach to TV by turning the knob.

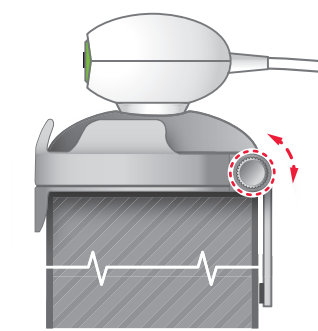

Choose the best method to aim the camera directly at your child's chest.

Need help? Go to www.leapfrog.com/support/leaptv

Part #15-1626-B