



2-in-1 Touch & Learn Tablet™



Parent's Guide

This guide contains important information. Please keep it for future reference.

91-003838-004

INTRODUCTION

Thank you for purchasing the **2-in-1 Touch & Learn Tablet™!** Enjoy a new kind of learning with the pretend tablet that has activities on one side and stories on the other. Twist and flip the tablet to change modes and explore 14+ touch-and-learn areas on each page!

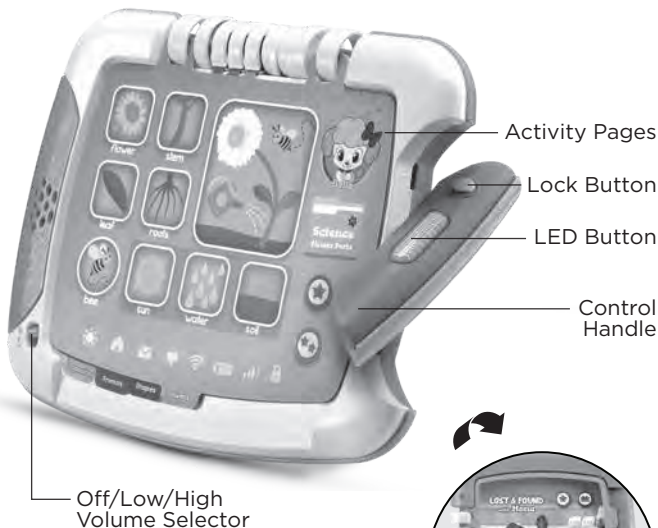

Story Pages



INCLUDED IN THIS PACKAGE

- **2-in-1 Touch & Learn Tablet™**
- Parent's guide

WARNING

All packing materials such as tape, plastic sheets, packaging locks, removable tags, cable ties and packaging screws are not part of this toy, and should be discarded for your child's safety.

NOTE

Please keep this parent's guide as it contains important information.

Unlock the Packaging Locks:

- ① Rotate the packaging locks 90 degrees anticlockwise.
- ② Pull out the packaging locks and discard.

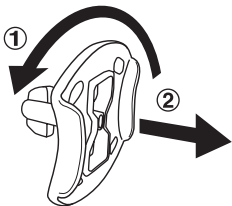

GETTING STARTED

BATTERY REMOVAL AND INSTALLATION

1. Make sure the unit is turned **Off**.
2. Locate the battery cover on the back of the unit. Use a screwdriver or coin to loosen the screw and open the battery cover.
3. If used batteries are present, remove these batteries from the unit by pulling up on one end of each battery.
4. Install 2 new 'AA' (AM-3/LR6) batteries following the diagram inside the battery box. (For best performance, alkaline batteries or fully charged Ni-MH rechargeable batteries are recommended).
5. Replace the battery cover and tighten the screw to secure.

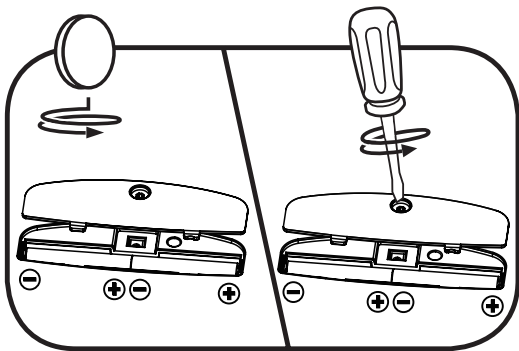

WARNING:

Adult assembly required for battery installation.
Keep batteries out of reach of children.

IMPORTANT: BATTERY INFORMATION

- Insert batteries with the correct polarity (+ and -).
- Do not mix old and new batteries.
- Do not mix alkaline, standard (carbon-zinc) or rechargeable batteries.
- Only batteries of the same or equivalent type as recommended are to be used.
- Do not short-circuit the supply terminals.
- Remove batteries during long periods of non-use.
- Remove exhausted batteries from the toy.
- Dispose of batteries safely. Do not dispose of batteries in fire.

RECHARGEABLE BATTERIES:

- Remove rechargeable batteries from the toy before charging.
- Rechargeable batteries are only to be charged under adult supervision.
- Do not charge non-rechargeable batteries.

Disposal of batteries and product



The crossed-out wheellie bin symbols on products and batteries, or on their respective packaging, indicates they must not be disposed of in domestic waste as they contain substances that can be damaging to the environment and human health.

The chemical symbols Hg, Cd or Pb, where marked, indicate that the battery contains more than the specified value of mercury (Hg), cadmium (Cd) or lead (Pb) set out in the Batteries and Accumulators Regulation.



The solid bar indicates that the product was placed on the market after 13th August, 2005.

Help protect the environment by disposing of your product or batteries responsibly.

VTech® cares for the planet.

Care for the environment and give your toy a second life by disposing of it at a small electricals collection point so all its materials can be recycled.

In the UK:

Visit www.recyclenow.com to see a list of collection points near you.

In Australia & New Zealand:

Check with your local council for kerbside collections.

NOTE

If the unit powers down or if the light fades out during play, please install a new set of batteries.

PRODUCT FEATURES

1. Off/Low/High Volume Selector

Slide the **Off/Low/High Volume Selector** to turn the toy on and select the volume.



2. Control Handle

To switch between the **Activity** and **Story Pages**, press the **Lock Button** and twist the **Control Handle**.

- **Activity to Story Pages:** Press and hold the **Lock Button**, then twist the **Control Handle** in the direction of the arrow.
- **Story to Activity Pages:** Press and hold the **Lock Button**, then twist the **Control Handle** in the direction of the arrow.



The **LED Button** should always face the player.

3. Activity Pages

Tap anywhere on the page to play and learn.

- Tap on the single star image to enter the Find-It game, where the player is asked to find objects on the **Activity Pages**. Each tap of the single star triggers three questions.
- Tap on the double star image to enter the Advanced Find-It game, where the player is asked to find different objects on the **Activity Pages** or more challenging questions. Each tap of the double star triggers three questions.



4. Story Pages

Tap anywhere on the page to interact with the story.

- Tap on the single star to enter the Find-It game, where the player is asked to find objects on the **Story Pages**. Each tap of the single star triggers three questions.
- Tap on the book image to hear the entire story.



5. LED Button

Press to play a unique tune for every set of **Activity** and **Story Pages**.

- Tune 1: Emotions - Cooper
- Tune 2: Counting - Buddy
- Tune 3: Flowers - Bella
- Tune 4: Shapes - Jake
- Tune 5: Animals - Pepper
- Tune 6: Opposites - Mona

The **LED Button** feature is not active while playing the Find-It game.

6. Automatic Shut-Off

To preserve battery life, the **2-in-1 Touch & Learn Tablet™** will automatically go into sleep mode after approximately 45 seconds without input. To turn the unit on again, turn a page, press the **LED button** or use the **Control Handle** to change modes.

CARE & MAINTENANCE

1. Keep the unit clean by wiping it with a slightly damp cloth.
2. Keep the unit out of direct sunlight and away from any direct heat sources.
3. Remove the batteries if the unit will not be in use for an extended period of time.
4. Do not drop the unit on a hard surface and do not expose the unit to moisture or water.

TROUBLESHOOTING

If for some reason the program/activity stops working, please follow these steps:

1. Turn the unit **Off**.
2. Interrupt the power supply by removing the batteries.
3. Let the unit stand for a few minutes, then replace the batteries.
4. Turn the unit back **On**. The unit should now be ready to use again.
5. If the unit still does not work, install a new set of batteries.

Environmental Phenomena

The unit may malfunction if subjected to radio-frequency interference. It should revert to normal operation when the interference stops. If not, it may become necessary to turn the power OFF and back ON, or remove and reinstall the batteries. In the unlikely event of an electrostatic discharge, the unit may malfunction and lose memory, requiring the user to reset the device by removing and reinstalling the batteries.

CONSUMER SERVICES

Creating and developing **LeapFrog®** products is accompanied by a responsibility that we at **LeapFrog®** take very seriously. We make every effort to ensure the accuracy of the information, which forms the value of our products. However, errors sometimes can occur. It is important for you to know that we stand behind our products and encourage you to call our Consumer Services Department with any problems and/or suggestions that you might have. A service representative will be happy to help you.

UK Customers:

Phone: 01702 200244 (from UK) or +44 1702 200244 (outside UK)

Website: www.leapfrog.co.uk/support

Australian Customers:

Phone: 1800 862 155

Website: support.leapfrog.com.au

NZ Customers:

Phone: 0800 400 785

Website: support.leapfrog.com.au

PRODUCT WARRANTY/ CONSUMER GUARANTEES

UK Customers:

Read our complete warranty policy online at leapfrog.com/warranty.

Australian Customers:

VTECH ELECTRONICS (AUSTRALIA) PTY LIMITED -
CONSUMER GUARANTEES

Under the Australian Consumer Law, a number of consumer guarantees apply to goods and services supplied by VTech Electronics (Australia) Pty Limited. Please refer to leapfrog.com/en-au/legal/warranty for further information.



***Visit our website for more
information about our products,
downloads, resources and more.***

leapfrog.com

LeapFrog Enterprises, Inc.
A subsidiary of VTech Holdings Limited.
TM & © 2020 LeapFrog Enterprises, Inc.
All rights reserved.
91-003838-004 