



Letter-Go-Round™



Instruction Manual

This manual contains important information. Please keep it for future reference.

INTRODUCTION

Thank you for purchasing the **Letter-Go-Round™**!

Learning colours, counting, letters and animal sounds has never been more fun! Tap the drum to count from 1-10 and learn about colours, or spin around the letter wheel to learn about animals from A to Z. Sit, spin, play and learn!

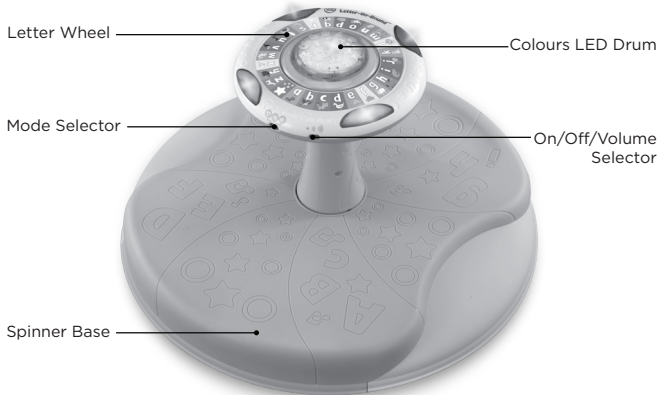

INCLUDED IN THE PACKAGE

- **Letter-Go-Round™**
- Quick Start Guide



Electronic panel



Supporting pillar

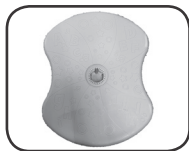

Spinner Base



Panel components A



Panel components B

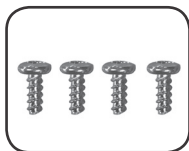

20 screws

ASSEMBLY

1. Place both Panel Components A to Spinner Base, letter side up.
2. Attach the two Panel Components A to the Spinner Base, using five screws per panel.

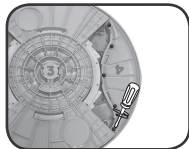
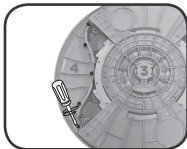
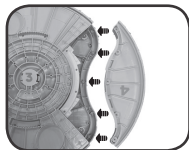
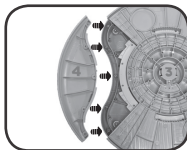

3. Place both Panel Components B next to the Spinner Base, letter side up.

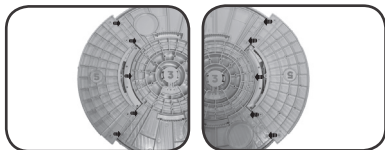

4. Attach the two Panel Components B to the Spinner Base, using five screws per panel.



5. Attach the Supporting Pillar to the Electronic Panel. You will hear a snap when the pieces are properly connected. These pieces cannot be taken apart after assembly.

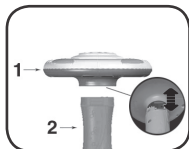

6. Attach the Supporting Pillar to the Spinner Base. You will hear a snap when the pieces are properly connected. These pieces cannot be taken apart after assembly.

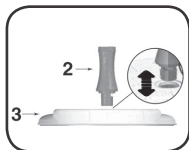

Suitable for children up to 55 lbs./25 kg.

WARNING

All packing materials such as tape, plastic sheets, packaging locks, removable tags, cable ties, cords and packaging screws are not part of this toy, and should be discarded for your child's safety.

NOTE

Please save this Instruction Manual as it contains important information.

Unlock the Packaging Locks

- ① Rotate the packaging locks 90 degrees anticlockwise.
- ② Pull out the packaging locks.

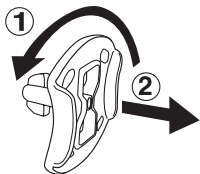

⚠CAUTION:

This package contains small screws.

ADULT ASSEMBLY REQUIRED.

For your child's safety, do not let your child play with the toy until it is fully assembled.

GETTING STARTED

BATTERY REMOVAL AND INSTALLATION

1. Make sure the unit is turned **OFF**.
2. Locate the battery cover on the back of the unit. Use a screwdriver to loosen the screw.
3. If used batteries are present, remove these batteries from the unit by pulling up on one end of each battery.
4. Install 2 new 'AA' (AM-3/LR6) batteries following the diagram inside the battery box. (For best performance, alkaline batteries or fully charged Ni-MH rechargeable batteries are recommended).
5. Replace the battery cover and tighten the screw to secure.

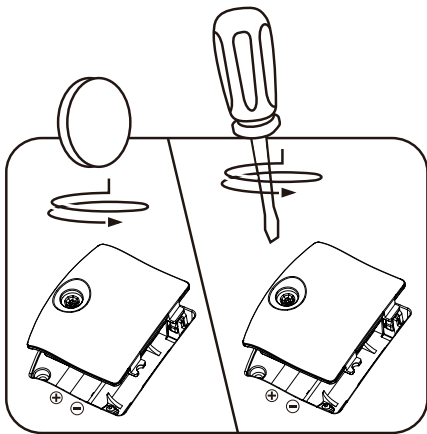

WARNING:

Adult assembly required for battery installation.
Keep batteries out of reach of children.

Disposal of batteries and product



The crossed-out wheellie bin symbols on products and batteries, or on their respective packaging, indicates they must not be disposed of in domestic waste as they contain substances that can be damaging to the environment and human health.

The chemical symbols Hg, Cd or Pb, where marked, indicate that the battery contains more than the specified value of mercury (Hg), cadmium (Cd) or lead (Pb) set out in Battery Directive (2006/66/EC).



The solid bar indicates that the product was placed on the market after 13th August, 2005.

Help protect the environment by disposing of your product or batteries responsibly.

LeapFrog® cares for the planet.

Care for the environment and give your toy a second life by disposing of it at a small electricals collection point so all its materials can be recycled.

In the UK:

Visit www.recyclenow.com to see a list of collection points near you.

In Australia & New Zealand:

Check with your local council for kerbside collections.

IMPORTANT: BATTERY INFORMATION

- Insert batteries with the correct polarity (+ and -).
- Do not mix old and new batteries.
- Do not mix alkaline, standard (carbon-zinc) or rechargeable batteries.
- Only batteries of the same or equivalent type as recommended are to be used.
- Do not short-circuit the supply terminals.
- Remove batteries during long periods of non-use.
- Remove exhausted batteries from the toy.
- Dispose of batteries safely. Do not dispose of batteries in fire.

RECHARGEABLE BATTERIES:

- Remove rechargeable batteries from the toy before charging.
- Rechargeable batteries are only to be charged under adult supervision.
- Do not charge non-rechargeable batteries.

PRODUCT FEATURES

1. On/Off/Volume Selector

Slide the **On/Off/Volume Selector** to turn the toy on and select the volume.



2. Letter Wheel

Sit on the **Spinner Base** and spin around the **Letter Wheel** while exploring 26 letters and animals.



3. Colour LED Drum

Tap the light-up colour LED **Drum** button to hear learning phrases in different modes.



4. Mode Selector

Move the **Mode Selector** to play in Letter mode, Colours & Counting mode, and Animal mode.



ACTIVITIES

Letter Mode

Sit on the **Spinner Base** and spin around the **Letter Wheel** and tap the **Drum** to hear letters and letter sounds.



Colours & Counting Mode

Sit on the **Spinner Base** and spin around the **Letter Wheel** to play a colour game and tap the **Drum** to count from 1 to 10.



Animal Mode

Sit on the **Spinner Base** and spin around the **Letter Wheel** and tap the **Drum** to hear animal names and animal sounds.



Song Lyrics:

Letter Song

Here we go round the alphabet, alphabet, alphabet.
Here we go round the alphabet from A to Z.

Animal Song

Animals, animals all around
Spin, spin yourself around and around

Colour Song

Red light, green light, give the wheel a spin!
Don't stop, don't stop, spin around again!
Let's go!

CARE & MAINTENANCE

1. Keep the unit clean by wiping it with a slightly damp cloth.
2. Keep the unit out of direct sunlight and away from any direct heat sources.
3. Remove the batteries if the unit will not be in use for an extended period of time.
4. Do not drop the unit on hard surfaces and do not expose the unit to moisture or water.
5. Try to change the batteries for new ones if the toy is not working properly.

CONSUMER SERVICES

Creating and developing **LeapFrog®** products is accompanied by a responsibility that we at **LeapFrog®** take very seriously. We make every effort to ensure the accuracy of the information, which forms the value of our products. However, errors sometimes can occur. It is important for you to know that we stand behind our products and encourage you to call our Consumer Services Department with any problems and/or suggestions that you might have. A service representative will be happy to help you.

UK Customers:

Phone: 01702 200244 (from UK) or +44 1702 200244 (outside UK)

Website: www.leapfrog.co.uk/support

Australian Customers:

Phone: 1800 862 155

Website: support.leapfrog.com.au

NZ Customers:

Phone: 0800 400 785

Website: support.leapfrog.com.au

PRODUCT WARRANTY/ CONSUMER GUARANTEES

UK Customers:

Read our complete warranty policy online at leapfrog.com/warranty.

Australian Customers:

VTECH ELECTRONICS (AUSTRALIA) PTY LIMITED -
CONSUMER GUARANTEES

Under the Australian Consumer Law, a number of consumer guarantees apply to goods and services supplied by VTech Electronics (Australia) Pty Limited. Please refer to leapfrog.com/en-au/legal/warranty for further information.



***Visit our website for more
information about our products,
downloads, resources and more.***

www.leapfrog.com

**Read our complete warranty policy online at
leapfrog.com/legal**

LeapFrog Enterprises, Inc.
A subsidiary of VTech Holdings Limited.
TM & © 2021 LeapFrog Enterprises, Inc.
All rights reserved.