



Interactive Learning Easel



Instruction Manual

This manual contains important information. Please save it for future reference.

INTRODUCTION

Thank you for purchasing the **Interactive Learning Easel!**

This 2-in-1 blackboard/whiteboard easel comes with 26 letter tiles, six shape tiles, chalk and an erasable marker. The interactive learning panel teaches letters and encourages creative play through drawing. The touch-sensitive pictures in the book describe how to use the magnetic shape tiles to draw pictures. The letter tile reader helps kids explore letter sounds, letter writing and new words.

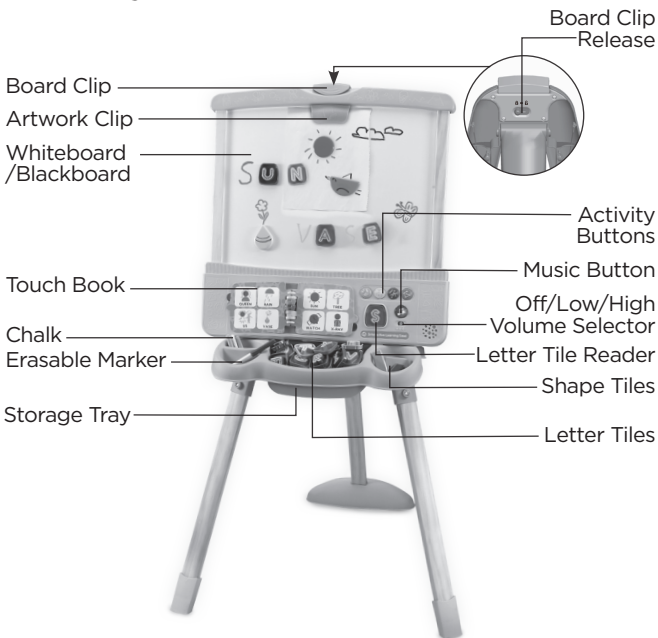

INCLUDED IN THE PACKAGE



A-Frame (1/2)



Storage Tray (1/2)



Connector (1)



Connector (2)



Learning Panel (3)



Upper Rear Leg (4)



Brace (5)



Lower Front Leg (6)



Lower Front Leg (7)



Lower Rear Leg



Rear Leg Base (8)

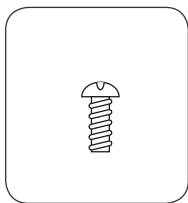

10 Screws

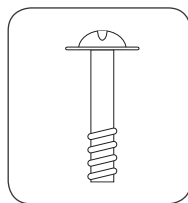

6 Bolts

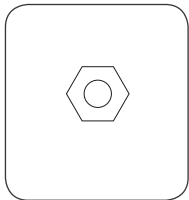

6 Nuts



Whiteboard/
Blackboard



26 Magnetic
Letter Tiles

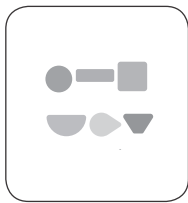

6 Magnetic Shape
Tiles



3 Chalk Pieces



1 Erasable Marker

- Quick Start Guide

WARNING

All packing materials such as tape, plastic sheets, packaging locks, removable tags, cable ties and packaging screws are not part of this toy, and should be discarded for your child's safety.

NOTE

Please save this Instruction Manual as it contains important information.

ATTENTION

Pour la sécurité de votre enfant, débarrassez-vous de tous les produits d'emballage tels que rubans adhésifs, feuilles de plastique, attaches, étiquettes, cordons et vis d'emballage. Ils ne font pas partie du jouet.

NOTE

Il est conseillé de sauvegarder ce manuel d'instructions car il comporte des informations importantes.

NOTE

Please ask us about the availability of FSC Products.

NOTE

Merci de nous consulter pour connaître la disponibilité des produits FSC.

Unlock the Packaging Locks

- ① Rotate the packaging locks 90 degrees counterclockwise.
- ② Pull out the packaging locks and discard.

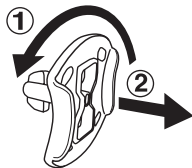

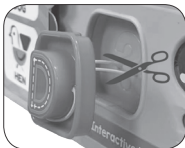

NOTE

Please cut and discard the cords before playing with the unit. The cords are not part of the product and should be discarded for your child's safety.



CAUTION:

Adult assembly required.
Small fasteners included.
CHOKING HAZARD—small parts.
Not for children under 3 yrs.



ATTENTION :

Ce jouet doit être assemblé par un adulte.
Petites attaches incluses.
RISQUE D'ÉTOUFFEMENT—Petites pièces.
Ne convient pas aux enfants de moins de 3 ans.

ASSEMBLY

With the **Interactive Learning Easel**, safety comes first. To ensure your child's safety, adult assembly is required.

ADULT ASSEMBLY REQUIRED:

Tool needed: Phillips-head screwdriver (not included)

Note: Numbers referenced below refer to the molded plastic numbers on assembly parts. See INCLUDED IN THE PACKAGE pages for reference.

1. Locate the marking of numbers 1 and 2 on the A-Frame and on the Storage Tray separately. Align **A-Frame 1** with **Storage Tray 1** and **A-Frame 2** with **Storage Tray 2**. The legs will rest in the slots until they are secured.



2. Lay the pieces face down on a flat surface so that the back of the **Storage Tray 1/2** and the back of the **A-Frame 1/2** are facing up.



3. Slide **Connector 1** into the slot formed by the aligned pieces **A-Frame 1** and **Storage Tray 1** with the number 1 on **Connector 1** facing up.



4. Use three **Screws** and your Phillips-head screwdriver to secure.

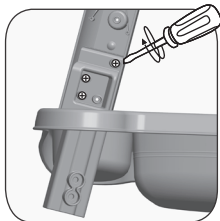

5. Slide **Connector 2** into the slot formed by the aligned pieces **A-Frame 2** and **Storage Tray 2** with the number 2 on **Connector 2** facing up.



6. Use three **Screws** and your Phillips-head screwdriver to secure.

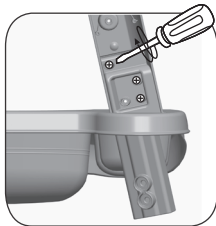

7. Slide the four knobs on the back of the Learning Panel 3 into the slots on the **A-Frame 1/2**. The **Learning Panel 3** will rest in the slots until it is secured.

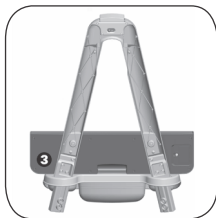

8. Secure **Learning Panel 3** to **A-Frame 1/2** with two **Screws** on each side as shown.

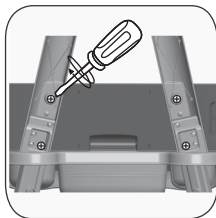

9. Snap **Upper Rear Leg 4** into the top of **A-Frame 1/2** as shown with the number 4 facing out.



10. Snap **Brace 5** into the back of **Learning Panel 3** as shown with the number 5 facing up.



11. Firmly snap the other end of **Brace 5** into the yellow slot in the back of **Upper Rear Leg 4** as shown. (Note: Once inserted, this piece cannot be removed.) You have now assembled the upper easel.



12. Lay the assembled upper easel face down on a flat surface.



13. Fit **Lower Front Leg 6** into **Connector 1** with the curved side of the leg facing down and the number 6 facing up. Secure with two **Nuts** and two **Bolts**, inserting the **Nuts** from the bottom.

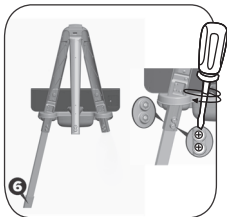

14. Fit **Lower Front Leg 7** into **Connector 2** with the curved side of the leg facing down and the number 7 facing up. Secure with two **Nuts** and two **Bolts**, inserting the **Nuts** from the bottom.

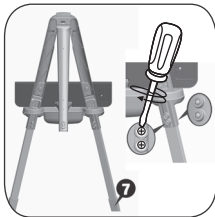

15. Fit **Lower Rear Leg** into the top of **A-Frame 1/2** with the curved side of the leg facing up. Secure with two **Nuts** and two **Bolts**, inserting the **Nuts** from the top.



16. Secure the **Lower Rear Leg** to the **Upper Rear Leg 4** with two **Nuts** and two **Bolts**.

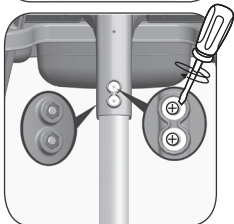

17. Insert Lower Rear Leg into Rear Leg Base 8.



18. Slot the **Whiteboard/Blackboard** onto the top of the Learning Panel. Lower the **Board Clip** over the **Whiteboard/Blackboard**.



19. Slide the **Board Clip Release** switch to the right and while holding it, lift the **Board Clip**.



20. Position the **Whiteboard/Blackboard** under the **Board Clip**. Release the clip to secure the **Whiteboard/Blackboard** in place. Repeat these steps when switching from whiteboard to blackboard.



SET-UP

- 1) After assembling the easel, place the **Erasable Marker** and **Chalk** pieces in the left cups of the Storage Tray.
- 2) Place the 26 magnetic **Letter Tiles** in the center cup of the **Storage Tray**.
- 3) Place the 6 magnetic **Shape Tiles** in the right cup of the **Storage Tray**.

Now, let's create and draw together!

GETTING STARTED

BATTERY REMOVAL AND INSTALLATION

1. Make sure the unit is turned **Off**.
2. Find the battery cover located on the back of the unit, use a screwdriver to loosen the screw, and then open the battery cover.
3. Remove old batteries by pulling up on one end of each battery.
4. Install 2 new AA (AM-3/LR6) batteries following the diagram inside the battery box. (For best performance, alkaline batteries or fully charged Ni-MH rechargeable batteries are recommended.)
5. Replace the battery cover and tighten the screw to secure.

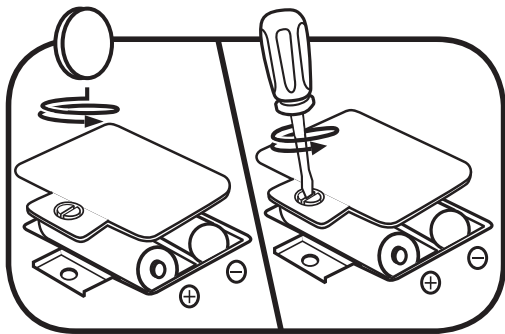



WARNING:

Adult assembly required for battery installation.
Keep batteries out of reach of children.



ATTENTION :

Les piles ou accumulateurs doivent être installés par un adulte. Tenir les piles ou accumulateurs hors de portée des enfants.

IMPORTANT: BATTERY INFORMATION

- Insert batteries with the correct polarity (+ and -).
- Do not mix old and new batteries.
- Do not mix alkaline, standard (carbon-zinc) or rechargeable batteries.
- Only batteries of the same or equivalent type as recommended are to be used.
- Do not short-circuit the supply terminals.
- Remove batteries during long periods of non-use.
- Remove exhausted batteries from the toy.
- Dispose of batteries safely. Do not dispose of batteries in fire.

RECHARGEABLE BATTERIES

- Remove rechargeable batteries (if removable) from the toy before charging.
- Rechargeable batteries are only to be charged under adult supervision.
- Do not charge non-rechargeable batteries.

PRODUCT FEATURES

1. Off/Low/High Volume Selector

To turn the unit **On**, slide the **Off/Low/High Volume Selector** to the Low » or High » position. To turn the unit **Off**, slide the **Off/Low/High Volume Selector** to the **Off ●** position.



2. Double-sided Whiteboard/Blackboard

Select either the whiteboard or blackboard side of the easel to explore a variety of activities. (See Assembly Instructions above for details on flipping and securing the board.)

Whiteboard side:

Use the erasable marker to draw and create pictures by drawing directly on and around the six magnetic **Shape Tiles**. Practice writing letters and spelling words using the erasable marker and the 26 magnetic **Letter Tiles**.



Blackboard side:

Use the three colored chalk pieces to draw and create pictures by tracing around the six magnetic **Shape Tiles**. Then fill them in with different colors or add fun details. Practice writing and spelling skills with the **Chalk** and 26 magnetic **Letter Tiles**.



3. 26 Magnetic Letter Tiles and Letter Tile Reader

Insert any of the **26 magnetic Letter Tiles** into the **Letter Tile Reader** to hear letter names, sounds and a word starting with that letter. Press to explore colors and vocabulary. Then remove the tiles to hear drawing and writing prompts.



4. Touch Book and 6 Magnetic Shape Tiles

Flip the pages and touch the pictures in the **Touch Book** to explore drawing and spelling. Then use the **Shape** or **Letter Tiles** to follow along.

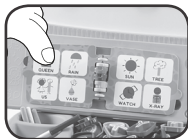



5. Four Activity Buttons

Press the buttons for music or art activities:

 **Drawing Music** - Fun tunes to accompany creative activities.

 **Shape Art Activity** - Use tiles and draw shapes to make patterns and pictures.

 **Rhythm Art Activity** - A game to draw lines and dots as you hear silly sounds.

 **Dot Art & Line Art Activities** - Explore how pictures are composed of simple dots and lines.



6. Light-Up Music Button

Press to hear four learning songs about the alphabet, colors, shapes and creativity while the light blinks along.



7. Erasable Marker and Three Chalk Pieces

Use the included **Erasable Marker** for activities on the whiteboard side and to draw directly onto the **Six Magnetic Shape Tiles**. Wipe the whiteboard with a damp cloth, dry with a dry cloth, and do it all over again! Use the included **Chalk** to write, draw or create art with, or trace around the **Shape Tiles** on the Blackboard side.

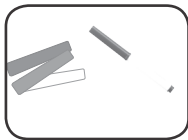

8. Storage Tray

Store all **26 magnetic Letter Tiles**, six **magnetic Shape Tiles**, **Erasable Marker** and **three Pieces of Chalk**.



9. Paper Clip

On the whiteboard side, place paper under the **Clip** to attach it to the board surface to create art or to display your child's artwork.



10. Automatic Shut-Off

To preserve battery life, the **Interactive Learning Easel** will automatically shut off after approximately 90 seconds without input. The unit can be turned on again by turning a book page, pressing any of the five buttons, or flipping the board over.

SONG LYRICS

Song 1

Grab your chalk and marker,
And let's go!
Use your imagination,
And let the art flow!

Song 2

Express yourself,
Create and play!
Make it silly or smart,
You can do it your way.

Draw a line,
Up and down.
Make it square,
Make it round.
Shapes and colors
are everywhere!

Song 3

Pictures are made,
With colors and shapes -
Red, green and blue.
Come on, let's make,
Circles and squares,
Rectangles, too.
It's fun to draw;
Yes, it's fun to do.

CARE & MAINTENANCE

1. Keep the unit clean by wiping it with a slightly damp cloth.
2. Keep the unit out of direct sunlight and away from any direct heat sources.
3. Remove the batteries if the unit will not be in use for an extended period of time.
4. Do not drop the unit on hard surfaces and do not expose the unit to moisture or water.

TROUBLESHOOTING

If for some reason the unit stops working or malfunctions, please follow these steps:

1. Turn the unit **Off**.
2. Interrupt the power supply by removing the batteries.
3. Let the unit stand for a few minutes, then replace the batteries.
4. Turn the unit **On**. The unit should now be ready to use again.
5. If the unit still does not work, install a new set of batteries.

Environmental Phenomena

The unit may malfunction if subjected to radio-frequency interference. It should revert to normal operation when the interference stops. If not, it may become necessary to turn the power **off** and back **on**, or remove and reinstall the batteries. In the unlikely event of an electrostatic discharge, the unit may malfunction and lose memory, requiring the user to reset the device by removing and reinstalling the batteries.

Impact de l'environnement

Une défaillance de fonctionnement de l'appareil peut survenir s'il est sujet à des interférences avec les fréquences radioélectriques. Le fonctionnement normal de l'appareil devrait reprendre avec l'arrêt des interférences. Si ce n'est pas le cas, il peut s'avérer nécessaire d'éteindre et rallumer l'appareil ou de retirer et réinstaller les piles. Dans l'éventualité peu probable d'une décharge électrostatique, un mauvais fonctionnement et une perte de mémoire de l'appareil peuvent se produire. L'utilisateur doit alors retirer et réinstaller les piles pour réinitialiser l'appareil.

CAUTION

Changes or modifications not expressly approved by the party responsible for compliance could void the user's authority to operate the equipment.

NOTE

This equipment has been tested and found to comply with the limits for a Class B digital device, pursuant to Part 15 of the FCC Rules. These limits are designed to provide reasonable protection against harmful interference in a residential installation. This equipment generates, uses and can radiate radio frequency energy and, if not installed and used in accordance with the instructions, may cause harmful interference to radio communications. However, there is no guarantee that interference will not occur in a particular installation. If this equipment does cause harmful interference to radio or television reception, which can be determined by turning the equipment off and on, the user is encouraged to try to correct the interference by one or more of the following measures:

- Reorient or relocate the receiving antenna.
- Increase the separation between the equipment and receiver.
- Connect the equipment into an outlet on a circuit different from that to which the receiver is connected.
- Consult the dealer or an experienced radio/TV technician for help.

IMPORTANT NOTE:

If the problem persists, please call our **Consumer Services Department** at **1-800-701-5327** in the U.S. and Canada, or email **support@leapfrog.com**. Creating and developing LeapFrog products is accompanied by a responsibility that we take very seriously. We make every effort to ensure the accuracy of the information, which forms the value of our products. However, errors sometimes can occur. It is important for you to know that we stand behind our products and encourage you to contact us with any problems and/or suggestions you might have. A service representative will be happy to help you.

Supplier's Declaration of Conformity

47 CFR § 2.1077 Compliance Information

Trade Name: LeapFrog®
Model: 6153
Product Name:
Responsible Party: LeapFrog Enterprises, Inc.
Address: 2200 Powell St., Suite 500
Emeryville, CA 94608
Website: leapfrog.com

THIS DEVICE COMPLIES WITH PART 15 OF THE FCC RULES. OPERATION IS SUBJECT TO THE FOLLOWING TWO CONDITIONS: (1) THIS DEVICE MAY NOT CAUSE HARMFUL INTERFERENCE, AND (2) THIS DEVICE MUST ACCEPT ANY INTERFERENCE RECEIVED, INCLUDING INTERFERENCE THAT MAY CAUSE UNDESIRE OPERATION.



**Visit our website for more
information about our products,
downloads, resources and more.**

leapfrog.com
leapfrog.ca

**Read our complete warranty policy online at
*leapfrog.com/legal***

LeapFrog Enterprises, Inc.,
A subsidiary of VTech Holdings Limited.
TM & © 2022 LeapFrog Enterprises, Inc.
All rights reserved.
IM-615300-000
Version:0