



Let's Record! Music Player™



Instruction Manual

This manual contains important information. Please save it for future reference.

INTRODUCTION

Thank you for purchasing the **Let's Record! Music Player™**! Sing and boogie as you explore letters, numbers, classical music and your inner superstar!



INCLUDED IN THE PACKAGE

- **Let's Record! Music Player™**
- Quick Start Guide

WARNING:

All packing materials such as tape, plastic sheets, packaging locks, removable tags, cable ties, cords and packaging screws are not part of this toy and should be discarded for your child's safety.

NOTE:

Please keep this Quick Start Guide as it contains important information.

Unlock the Packaging Locks

- ① Rotate the packaging lock 90 degrees anticlockwise.
- ② Pull out the packaging lock and discard.

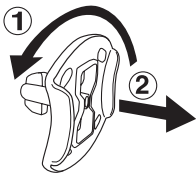

Activate Normal Play Mode

This product is in Try-Me mode in the packaging. To activate normal play mode, please complete the following steps:

1. Slide the On/Off Switch to the Off position.
2. Slide the On/Off Switch to the On position to activate normal play mode.

INSTRUCTIONS

Battery Removal and Installation

1. Make sure the unit is turned **OFF**.
2. Locate the battery cover on the back of the unit. Use a screwdriver to loosen the screw and then open the battery cover.
3. If used batteries are present, remove these batteries from the unit by pulling up on one end of each battery.
4. Install 4 new AA (AM-3/LR6) batteries following the diagram inside the battery box. (For best performance, alkaline batteries or fully charged Ni-MH rechargeable batteries are recommended.)
5. Replace the battery cover and tighten the screw to secure.

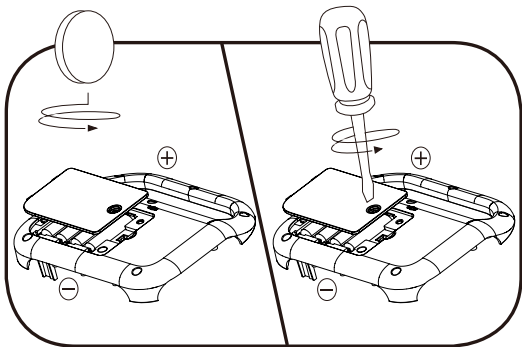

WARNING:

Adult assembly required for battery installation.
Keep batteries out of reach of children.

IMPORTANT: BATTERY INFORMATION

- Insert batteries with the correct polarity (+ and -).
- Do not mix old and new batteries.
- Do not mix alkaline, standard (carbon-zinc) or rechargeable batteries.
- Only batteries of the same or equivalent type as recommended are to be used.
- Do not short-circuit the supply terminals.
- Remove batteries during long periods of non-use.
- Remove exhausted batteries from the toy.
- Dispose of batteries safely. Do not dispose of batteries in fire.

RECHARGEABLE BATTERIES:

- Remove rechargeable batteries from the toy before charging.
- Rechargeable batteries are only to be charged under adult supervision.
- Do not charge non-rechargeable batteries.

Bluetooth Statement

The *Bluetooth*® word mark and logos are registered trademarks owned by the *Bluetooth*® SIG, Inc. and any use of such marks by **VTech**® is under license. Other trademarks and trade names are those of their respective owners.

DECLARATION OF CONFORMITY

Hereby, Leapfrog, a division of VTech Electronics Europe Plc, declares that the radio equipment type 6155 is in compliance with The Radio Equipment Regulations 2017 (2017 No.1206). The full text of the Declaration of conformity is available at the following internet address:
www.leapfrog.com/en-gb/legal/eudoc
Frequency Band: 2402MHz – 2480MHz
Maximum RF power: 3.9 mW (4 dBm)

Disposal of batteries and product



The crossed-out wheellie bin symbols on products and batteries, or on their respective packaging, indicates they must not be disposed of in domestic waste as they contain substances that can be damaging to the environment and human health.

The chemical symbols Hg, Cd or Pb, where marked, indicate that the battery contains more than the specified value of mercury (Hg), cadmium (Cd) or lead (Pb) set out in the Batteries and Accumulators Regulation.



The solid bar indicates that the product was placed on the market after 13th August, 2005.

Help protect the environment by disposing of your product or batteries responsibly.

LeapFrog® cares for the planet.

Care for the environment and give your toy a second life by disposing of it at a small electricals collection point so all its materials can be recycled.

In the UK:

Visit www.recyclenow.com to see a list of collection points near you.

In Australia & New Zealand:

Check with your local council for kerbside collections.

PRODUCT FEATURES

1. On/Off Switch

Slide the **On/Off Switch** to turn the toy on and off.

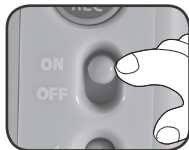

2. Record Button

Press the **Record Button** and then listen to the instructions to record your own audio. Each numbered button can save a three-minute piece of audio.



3. Volume Control

Rotate the **Volume Dial** up or down to adjust the volume level.

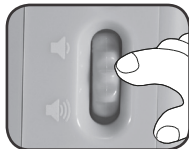

4. Headphone Port

Insert headphones (not included) for on-the-go listening fun.

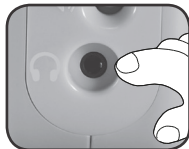

5. Mode Dial

Turn the **Mode Dial** to choose a mode. After selecting a mode, press a **Song Button** to play an individual song or press the **Play/Pause Button** to play all the songs in order.

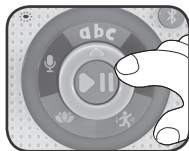

6. Play/Pause Button

Press to hear a selected mode, song, melody or recording. Press again to pause.

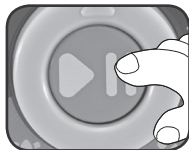

7. Bluetooth® Button

Press and hold for three seconds to activate **Bluetooth®** wireless technology. Open your personal **Bluetooth®** device to initiate pairing. To clear any previous device connections, press and hold the **Play/Pause Button** for five seconds.

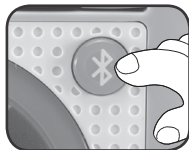

8. Song Buttons

Press to play a song, melody or recording.



9. Microphone

Speak into the microphone when using the record feature.

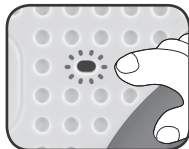

ACTIVITIES

1. Learning Songs

Turn the **Mode Dial** to Learning Songs **abc** and press a **Song Button** to select from ten educational songs.



2. All Star Classics

Turn the **Mode Dial** to All Star Classics and press a **Song Button** to select from ten favourite children's songs. ★



3. Active Songs

Turn the **Mode Dial** to Active Songs and press a **Song Button** to select from ten active movement songs. 🏃



4. Relaxing Music Mode

Turn the **Mode Dial** to Relaxing Music and press a **Song Button** to select from ten lullabies and classical music pieces. 🌸



5. Record and Play

Turn the **Mode Dial** to Record and Play 🎤 and press a **Song Button** to select from your recorded audio.



SONGS AND MELODIES

Learning Songs

1. The Alphabet Song
2. Counting from 1 to 10
3. All the Colours of the Rainbow
4. Love Grows
5. The Days of the Week
6. Wash Your Hands
7. Five Little Birdies
8. Clean Up
9. On the Farm We Can Play
10. What Is the Weather Like Outside Today?

All Star Classics

1. Old MacDonald Had a Farm
2. Twinkle, Twinkle, Little Star
3. Bingo
4. The Wheels on the Bus
5. Down by the Bay
6. I'm a Little Teapot
7. The Muffin Man
8. London Bridge
9. Row, Row, Row Your Boat
10. Five Little Speckled Frogs

Active Songs

1. Animal Rock
2. Can You Hear?
3. Animal Jive
4. Scrub That Body
5. Animal Sounds
6. Let's Go on a Stroll Together
7. Wheels on the Bus
8. Dem Bones
9. Let's Do the Funky Bear
10. Tick Tock

Relaxing Music

1. Hush Little Baby
2. Beethoven's "Ode to Joy"
3. Brahms' "Lullaby"
4. Pachelbel's "Canon in D"
5. Bach's "Minuet in G"
6. Ocean Waves - Music of the Sea
7. Vivaldi's "Spring"
8. Frère Jacques
9. Beethoven's "Für Elise"
10. Goodnight ABC's

CARE & MAINTENANCE

1. Keep the unit clean by wiping it with a slightly damp cloth.
2. Keep the unit out of direct sunlight and away from any direct heat sources.
3. Remove the batteries if the unit will not be in use for an extended period of time.
4. Do not drop the unit on hard surfaces and do not expose the unit to moisture or water.
5. Try to change the batteries for new ones if the toy is not working properly.

TROUBLESHOOTING

If for some reason the unit stops working or malfunctions, please follow these steps:

1. Turn the unit **Off**.
2. Interrupt the power supply by removing the batteries.
3. Let the unit stand for a few minutes, then replace the batteries.
4. Turn the unit back **On**. The unit should now be ready to play again.
5. If the unit still does not work, replace with an entire set of new batteries.

Environmental phenomena

The unit may malfunction if subjected to radio-frequency interference. It should revert to normal operation when the interference stops. If not, it may become necessary to turn the power **OFF** and back **ON**, or remove and reinstall the batteries. In the unlikely event of an electrostatic discharge, the unit may malfunction and lose memory, requiring the user to reset the device by removing and reinstalling the batteries.

CONSUMER SERVICES

Creating and developing **LeapFrog®** products is accompanied by a responsibility that we at **LeapFrog®** take very seriously. We make every effort to ensure the accuracy of the information, which forms the value of our products. However, errors sometimes can occur. It is important for you to know that we stand behind our products and encourage you to call our Consumer Services Department with any problems and/or suggestions that you might have. A service representative will be happy to help you.

UK Customers:

Phone: 01702 200244 (from UK) or +44 1702 200244 (outside UK)

Website: www.leapfrog.co.uk/support

Australian Customers:

Phone: 1800 862 155

Website: support.leapfrog.com.au

NZ Customers:

Phone: 0800 400 785

Website: support.leapfrog.com.au

PRODUCT WARRANTY/ CONSUMER GUARANTEES

UK Customers:

Read our complete warranty policy online at leapfrog.com/warranty.

Australian Customers:

VTECH ELECTRONICS (AUSTRALIA) PTY LIMITED -
CONSUMER GUARANTEES

Under the Australian Consumer Law, a number of consumer guarantees apply to goods and services supplied by VTech Electronics (Australia) Pty Limited. Please refer to leapfrog.com/en-au/legal/warranty for further information.



***Visit our website for more
information about our products,
downloads, resources and more.***

www.leapfrog.com

LeapFrog Enterprises, Inc.
A subsidiary of VTech Holdings Limited.
TM & © 2022 LeapFrog Enterprises, Inc.
All rights reserved.
IM-615500-001
Version:0