



Tappin' Colors 2-in-1 Xylophone™



Instruction Manual

This manual contains important information. Please save it for future reference.

INTRODUCTION

Thank you for purchasing the **Tappin' Colors 2-in-1 Xylophone™**. Strike up the band with learning and lights! Remove the wooden tambourine from the xylophone so a friend can join the band. Tap the eight light-up keys with the mallet to learn colors and numbers. Practice the scales with three different instrument sounds. Follow the lights to play eight well-loved melodies. Jam along to the background music. Follow the included sheet music to play four familiar melodies.

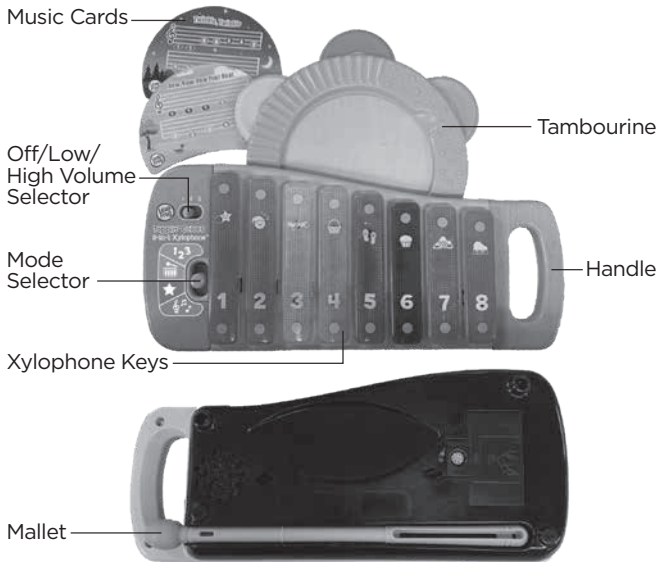

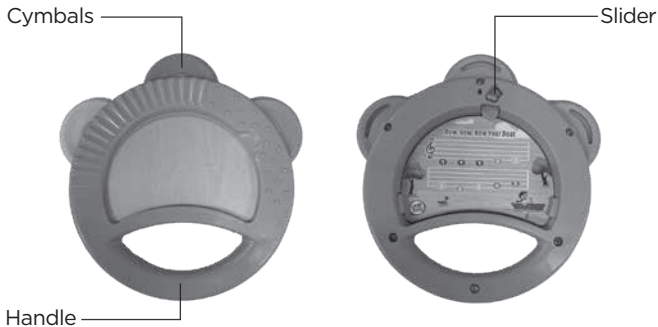

INCLUDED IN THE PACKAGE

- Tappin' Colors 2-in-1 Xylophone™
- Mallet
- Tambourine
- 2 Music Cards
- Quick Start Guide

WARNING

All packing materials such as tape, plastic sheets, packaging locks, removable tags, cable ties and packaging screws are not part of this toy, and should be discarded for your child's safety.

NOTE

Please save this Instruction Manual as it contains important information.

ATTENTION

Pour la sécurité de votre enfant, débarrassez-vous de tous les produits d'emballage tels que rubans adhésifs, feuilles de plastique, attaches, étiquettes, cordons et vis d'emballage. Ils ne font pas partie du jouet.

NOTE

Il est conseillé de sauvegarder ce manuel d'instructions car il comporte des informations importantes.

NOTE

Please ask us about the availability of FSC Products.

NOTE

Merci de nous consulter pour connaître la disponibilité des produits FSC.

Warning. Do not use close to the ear! Misuse may cause damage to hearing.

Unlock the Packaging Locks

- ① Rotate the packaging locks 90 degrees counterclockwise.
- ② Pull out the packaging locks and discard.

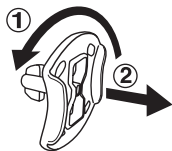

Unlock the Packaging Lock

- ① Rotate the packaging lock counterclockwise several times.
- ② Pull out and discard the packaging lock.

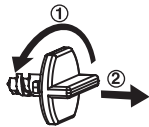

GETTING STARTED

BATTERY REMOVAL AND INSTALLATION

1. Make sure the unit is turned **Off**.
2. Find the battery cover located on the back of the unit, use a screwdriver to loosen the screw, and then open the battery cover.
3. Remove old batteries by pulling up on one end of each battery.
4. Install 2 new AA (AM-3/LR6) batteries following the diagram inside the battery box. (For best performance, alkaline batteries or fully charged Ni-MH rechargeable batteries are recommended.)
5. Replace the battery cover and tighten the screw to secure.

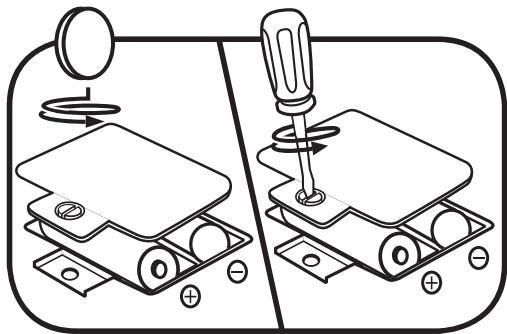



WARNING:

Adult assembly required for battery installation.
Keep batteries out of reach of children.



ATTENTION :

Les piles ou accumulateurs doivent être installés par un adulte. Tenir les piles ou accumulateurs hors de portée des enfants.

IMPORTANT: BATTERY INFORMATION

- Insert batteries with the correct polarity (+ and -).
- Do not mix old and new batteries.
- Do not mix alkaline, standard (carbon-zinc) or rechargeable batteries.
- Only batteries of the same or equivalent type as recommended are to be used.
- Do not short-circuit the supply terminals.
- Remove batteries during long periods of non-use.
- Remove exhausted batteries from the toy.
- Dispose of batteries safely. Do not dispose of batteries in fire.

RECHARGEABLE BATTERIES

- Remove rechargeable batteries (if removable) from the toy before charging.
- Rechargeable batteries are only to be charged under adult supervision.
- Do not charge non-rechargeable batteries.

NOTE

If the unit powers down or if the light fades out during play, please install a new set of batteries.



PRODUCT FEATURES

1. Off/Low/High Volume Selector

To turn the unit **On**, slide the **Off/Low/High Volume Selector** to the Low » or High » position. To turn the unit **Off**, slide the **Off/Low/High Volume Selector** to the **Off ●** position.



2. Mode Selector

Slide to the **Mode Selector** to choose Learn mode **123**, Instruments mode , Game mode  or Jam Along mode .



3. Light-Up Keys & Mallet

Remove the **Mallet** from the back of the unit. Then, tap any of the eight light-up Xylophone Keys.



4. Handle

The built-in **Handle** on the xylophone makes it easy to carry.



5. Tambourine

Remove the tambourine from the slot in the top of the xylophone. Then shake it or tap the wooden center to play rhythms. Invite a friend to play music together!



6. Music Cards

Place one of the two double-sided **Music Cards** in the wooden center of the tambourine while it's inserted in the xylophone. Then follow the numbered or colored notes to play the melody. Secure and store the **Music Cards** in the back of the tambourine with the **Slider**.

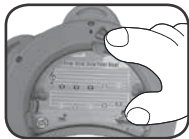

NOTE

Find more downloadable sheet music at leapfrog.com/xylophone

7. Automatic Shut-Off

To preserve battery life, the **Tappin' Colors 2-in-1 Xylophone™** will automatically shut off after approximately 60 seconds without input. The unit can be turned on again by sliding the **Mode Selector** or tapping one of the **Xylophone Keys**.

ACTIVITIES

1. Learn Mode

Move the **Mode Selector** to Learn mode, then tap the keys to learn about color names or numbers. Each time the mode is selected, it alternates playing Numbers or Colors. If the tambourine is inserted, you will also hear a background tune.



2. Instruments Mode

Move the **Mode Selector** to Instruments mode. Tap the keys to hear one of three instrument names and sounds: xylophone, glockenspiel or strings. If the tambourine is inserted, you will also hear a background tune.



3. Game Mode

Move the **Mode Selector** to Game mode. Press any of the eight light-up **Xylophone Keys** to learn eight well-known children's melodies. Follow the lights to play a melody by striking the keys in order. The key numbers indicate increasing levels of challenge in playing back the tunes. When all the notes of the tune have been played, you will hear the full melody played back.











4. Jam Along Mode

Move the **Mode Selector** to Jam Along mode, then tap the keys to jam along to nine original tunes. Remove the tambourine and shake or tap it to add your own rhythms. Invite a friend to join the band!



MELODIES

1. Twinkle, Twinkle, Little Star 
2. Are You Sleeping? 
3. Row, Row, Row Your Boat 
4. A Tisket, A Tasket 
5. Looby Loo 
6. The Muffin Man 
7. On Top of Old Smokey 
8. Chop Waltz 

SONG LYRICS

Xylophone Song

Playing music on my xylophone.
Grab a tambourine and play along!

CARE & MAINTENANCE

1. Keep the unit clean by wiping it with a slightly damp cloth.
2. Keep the unit out of direct sunlight and away from any direct heat sources.
3. Remove the batteries if the unit will not be in use for an extended period of time.
4. Do not drop the unit on hard surfaces and do not expose the unit to moisture or water.

TROUBLESHOOTING

If for some reason the unit stops working or malfunctions, please follow these steps:

1. Turn the unit **Off**.
2. Interrupt the power supply by removing the batteries.
3. Let the unit stand for a few minutes, then replace the batteries.
4. Turn the unit **On**. The unit should now be ready to use again.
5. If the unit still does not work, install a new set of batteries.

Environmental Phenomena

The unit may malfunction if subjected to radio-frequency interference. It should revert to normal operation when the interference stops. If not, it may become necessary to turn the power **off** and back **on**, or remove and reinstall the batteries. In the unlikely event of an electrostatic discharge, the unit may malfunction and lose memory, requiring the user to reset the device by removing and reinstalling the batteries.

Impact de l'environnement

Une défaillance de fonctionnement de l'appareil peut survenir s'il est sujet à des interférences avec les fréquences radioélectriques. Le fonctionnement normal de l'appareil devrait reprendre avec l'arrêt des interférences. Si ce n'est pas le cas, il peut s'avérer nécessaire d'éteindre et rallumer l'appareil ou de retirer et réinstaller les piles. Dans l'éventualité peu probable d'une décharge électrostatique, un mauvais fonctionnement et une perte de mémoire de l'appareil peuvent se produire. L'utilisateur doit alors retirer et réinstaller les piles pour réinitialiser l'appareil.

CAUTION

Changes or modifications not expressly approved by the party responsible for compliance could void the user's authority to operate the equipment.

NOTE

This equipment has been tested and found to comply with the limits for a Class B digital device, pursuant to Part 15 of the FCC Rules. These limits are designed to provide reasonable protection against harmful interference in a residential installation. This equipment generates, uses and can radiate radio frequency energy and, if not installed and used in accordance with the instructions, may cause harmful interference to radio communications. However, there is no guarantee that interference will not occur in a particular installation. If this equipment does cause harmful interference to radio or television reception, which can be determined by turning the equipment off and on, the user is encouraged to try to correct the interference by one or more of the following measures:

- Reorient or relocate the receiving antenna.
- Increase the separation between the equipment and receiver.
- Connect the equipment into an outlet on a circuit different from that to which the receiver is connected.
- Consult the dealer or an experienced radio/TV technician for help.

IMPORTANT NOTE:

If the problem persists, please call our **Consumer Services Department** at **1-800-701-5327** in the U.S. and Canada, or email **support@leapfrog.com**. Creating and developing LeapFrog products is accompanied by a responsibility that we take very seriously. We make every effort to ensure the accuracy of the information, which forms the value of our products. However, errors sometimes can occur. It is important for you to know that we stand behind our products and encourage you to contact us with any problems and/or suggestions you might have. A service representative will be happy to help you.

Supplier's Declaration of Conformity

47 CFR § 2.1077 Compliance Information

Trade Name: LeapFrog®
Model: 6156
Product Name: Tappin' Colors 2-in-1 Xylophone™
Responsible Party: LeapFrog Enterprises, Inc.
Address: 2200 Powell St., Suite 500
Emeryville, CA 94608
Website: leapfrog.com

THIS DEVICE COMPLIES WITH PART 15 OF THE FCC RULES. OPERATION IS SUBJECT TO THE FOLLOWING TWO CONDITIONS: (1) THIS DEVICE MAY NOT CAUSE HARMFUL INTERFERENCE, AND (2) THIS DEVICE MUST ACCEPT ANY INTERFERENCE RECEIVED, INCLUDING INTERFERENCE THAT MAY CAUSE UNDESIRE OPERATION.



**Visit our website for more
information about our products,
downloads, resources and more.**

leapfrog.com

leapfrog.ca

Read our complete warranty policy online at

leapfrog.com/legal

LeapFrog Enterprises, Inc.,
A subsidiary of VTech Holdings Limited.
TM & © 2022 LeapFrog Enterprises, Inc.
All rights reserved.

IM-615600-000

Version:0