



LeapPods Max™



Instruction Manual

This manual contains important information.
Please keep it for future reference.

INTRODUCTION

Thank you for purchasing the **LeapPods Max™** headphones! Dance to party songs, experience immersive adventures, unwind with instrumental music or use with your own **Bluetooth®** wireless technology enabled devices!

Adjustable Headband

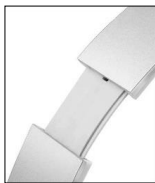

INCLUDED IN THE PACKAGE



- LeapPods Max™



- Adventure Passport booklet



- Micro-USB cable



- Quick Start Guide

WARNING

All packing materials, including tape, plastic sheets, packaging locks, removable tags, cable ties, cords and packaging screws are not part of this toy, and should be discarded for your child's safety.

NOTE

Please save this Instruction Manual as it contains important information.

GETTING STARTED

When you use the **LeapPods Max™** for the first time, move the **On/Off Switch** to the On position (). When powered on, the **Indicator Light** will turn green.

Battery Charging

Note: Adult operation required.

The LeapPods Max™ cannot be used while charging, even if power is turned on.

When the battery is low, the **Indicator Light** will turn red. To charge the **LeapPods Max™**, connect it to a computer using the included **Micro-USB Cable**. To do so correctly, please follow these steps:

- Please charge the **LeapPods Max™** before first use.
- The **LeapPods Max™** can be charged either in On or Off mode.
- Open the rubber cover of the **USB Charging Port** on the bottom of the **LeapPods Max™**.
- Insert the small end of the included **Micro-USB Cable** into the **USB Charging Port** on the **LeapPods Max™**.
- Insert the large end of the included **Micro-USB Cable** into a USB port on your computer.
- The **Indicator Light** will turn orange while the **LeapPods Max™** is charging. After the battery is fully charged, the **Indicator Light** will turn green. You may then disconnect your fully charged **LeapPods Max™** headphones from the computer.
- This toy contains a rechargeable battery that is non-replaceable.

USB port for battery charging:

The current output of USB \Rightarrow DC 5V, with a minimum of 0.5A

Guidelines for Charging With the Micro-USB Cable

Charge this device using the included **Micro-USB Cable** connected to a computer. Do not charge using a third party adaptor. Before use, inspect the cord to confirm that it is in good condition and that there are no breaks or exposed wires. Ensure there are no particles or liquid (water, juice, etc.) in either of the connectors before plugging in either end of the cable. The device should be completely dry with no debris in the cable connectors when charging. Securely plug in the cable in the correct orientation. Never leave the device unattended while charging. Do not charge your device on soft surfaces, as they can trap heat around the device.

Typical charging time is approximately 2-3 hours if the battery is fully depleted. Disconnect the device when it is fully charged. Do not leave the device charging for more than 4 hours. The actual charging time depends on the charging current, the remaining charge in the battery prior to recharging and the ambient temperature. The optimum ambient temperature is 32°F - 104°F (0°C - 40°C).

Battery Life

The time the battery lasts between charges depends on usage. Like other electronic devices, more frequent usage will drain the battery more quickly. When the battery level is low as shown by the red **Indicator Light**, it is recommended to charge the battery before further use. When the battery level is too low, the **LeapPods Max™** will not turn on until it is sufficiently recharged.

Battery Maintenance

Charge the battery regularly for optimal performance, even when the **LeapPods Max™** is not regularly in use. For example, charge the **LeapPods Max™** at least once every six months.

Australia/New Zealand

WARNING! SAFETY INSTRUCTIONS, PLEASE READ THOROUGHLY BEFORE GIVING THIS PRODUCT TO A CHILD. KEEP AWAY FROM FIRE OR HEAT SOURCE.

BATTERIES CANNOT BE REPLACED

The batteries in this toy are permanently encased. Before giving this toy to a child make sure there are no signs of damage. Regularly check the toy and dispose of it immediately if there are any signs of damage. Do not dispose of the toy in a fire, as the batteries may leak and explode. Keep batteries safely out of children's reach before disposing of them via a safe disposal system.

Disposal of batteries and product



The crossed-out wheellie bin symbols on products and batteries, or on their respective packaging, indicates they must not be disposed of in domestic waste as they contain substances that can be damaging to the environment and human health.

The chemical symbols Hg, Cd or Pb, where marked, indicate that the battery contains more than the specified value of mercury (Hg), cadmium (Cd) or lead (Pb) set out in the Batteries and Accumulators Regulation.



The solid bar indicates that the product was placed on the market after 13th August, 2005.

Help protect the environment by disposing of your product or batteries responsibly.

LeapFrog® cares for the planet.

Care for the environment and give your toy a second life by disposing of it at a small electricals collection point so all its materials can be recycled.

In the UK:

Visit www.recyclenow.com to see a list of collection points near you.

In Australia & New Zealand:

Check with your local council for kerbside collections.

PRODUCT FEATURES

1. On/Off Switch

Slide the **On/Off Switch** to the On position. When powered on, the **Indicator Light** will turn green.

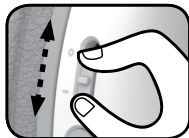

2. Pairing Button

Press the **Pairing Button** to connect with other **Bluetooth®** devices.

Note: See the Pairing Mode section below for instructions.

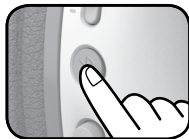

3. Mode Select Dial

Rotate the **Mode Select Dial** to choose a category: Dance Party, Adventures, Learning Songs, Challenges, Quiet Time and Instrumentals.



4. Play/Pause Button

Press the **Play/Pause Button** to play or pause the track.

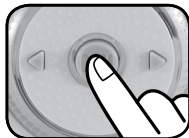

5. Next Button

Press the **Next Button** to skip to the next track in the category.



6. Back Button

Press the **Back Button** once to go back to the beginning of the current track. Press the **Back Button** again to skip to the previous track in the category.



7. Volume Button

Press the + on the **Volume Button** to increase the volume and press the - on the **Volume Button** to decrease the volume.

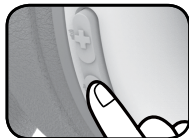

8. Adjustable Headband

The headband can be adjusted by gently pulling the headphones down from the headband.

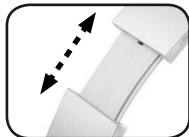

9. USB Charging Port

Connect the unit to your computer using the included **Micro-USB Cable** to charge the headphones.

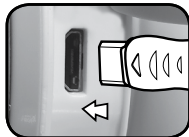

10. Audio Port

Connect to other devices using the 3.5mm Audio Cable (not included).

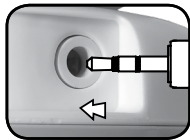

11. Automatic Shut-Off

To preserve battery life, the unit will automatically go to sleep after 5 minutes of inactivity. The unit can be woken up by pressing the **Play Button**.

PLAY MODES

1. Pairing Mode

- Press the **Pairing Button** to turn the **Bluetooth®** connection on or off. Press and hold the **Pairing Button** for 3 seconds to go into Pairing Mode.
- The **Indicator Light** will flash blue when waiting for a connection.
- Choose the **LeapPods Max™** from your peer device to send the connection request. Press and hold the **Play Button** for 3 seconds to confirm. **Bluetooth®** will be disconnected after 60 seconds if the connection is not confirmed.
- When the connection is confirmed, the **Indicator Light** will turn solid blue.
- The **LeapPods Max™** will automatically connect to confirmed devices.

2. Line-In Mode

Make sure the headphones are powered on. Plug in the 3.5mm Audio Cable (not included) to the **3.5mm Audio Port** on the headphones and connect the other end to an external device.

ACTIVITIES

Content Categories

There are six categories of content:

Dance Party

1. Dance-O-Rama Llama
2. Stinky Bean
3. Dance Together
4. Don't Stop Dancing
5. Dance It Out
6. Nature's Music
7. Through the Seasons
8. Dancing Robots
9. Just Bounce

Adventures

Explore with the **Adventure Passport** booklet to enhance the fun.

1. Amazon Rainforest
2. African Savanna
3. Under the Sea
4. Australian Animal Sanctuary
5. The Countryside
6. Deciduous Forest



Learning Songs

1. Dew Drops
2. Brush My Teeth
3. Pick It Up
4. Wash My Hands
5. Super Hero Helper
6. I Am Me
7. Mistakes Are Okay
8. Grow Little Seed
9. Counting Dandelions
10. Healthy Snacks

Challenges

1. Wiggle Freeze
2. Bird's the Word
3. Pop and Flop
4. Bunny Hop Hopscotch
5. Twinkle Toes
6. Ocean Motions
7. Creepy Crawlies
8. Jumpin' Jellybeans

Quiet Time

1. I Am Still
2. My Actions Matter
3. I Am Patient
4. Kindness
5. Having Gratitude
6. My Body is Strong
7. Relax and Reset
8. Breathe With Me
9. Trying New Things
10. Practise Makes Progress

Instrumentals

1. Gentle Storm
2. Dancing Trees
3. Summer Nights
4. Buzzing Energy
5. Simple Beats
6. Hidden Journey
7. Playful Winds
8. Magenta Wings
9. Exciting Adventure
10. Desert Sunset

CARE & MAINTENANCE

- Keep the rubber cover over the **Micro-USB Port** closed tightly when not in use in order to prevent dust or water from getting in.
- Keep the **LeapPods Max™** and accessories clean by wiping them with a slightly damp cloth. Never use solvents or abrasives.
- Always keep the **LeapPods Max™** headphones away from water.
- Keep the **LeapPods Max™** out of direct sunlight and away from any direct heat sources.
- Turn off the **LeapPods Max™** if not being used for an extended period of time.
- Avoid dropping the **LeapPods Max™**. NEVER try to dismantle it.
- Do not leave the **LeapPods Max™** plugged in for extended periods of time.
- Use the **Micro-USB Cable** that came with this device to charge it.
- **Micro-USB Cable** with ferrite must be used with this equipment to ensure compliance with the EMC Directive 2004/108/EC limits.

- Examine the **Micro-USB Cable** regularly, checking for damage to the cable, plug and other parts. Do not use the **Micro-USB Cable** if there is any damage.

Important Safety Instructions

- As with all electrical products, precautions should be observed during handling to prevent electric shock.
- The **Micro-USB Cable** could be a strangulation hazard. Keep out of reach of children under 3 years of age. The **Micro-USB Cable** should be used only by an adult when connecting to a computer and is to be removed by an adult prior to the use of the product by a child.
- Routinely check the **LeapPods Max™** for proper and safe condition. If there is any damage or broken parts, remove from use.
- The **LeapPods Max™** should only to be connected to equipment bearing either of the following symbols:  or .
- Adult supervision required at all times while children are playing with this product.
- Always turn the volume level of your headphones down to a low level before placing the headphones on your (or your child's) head. Gradually turn up the volume until you achieve a comfortable level.
- It is not recommended to use this product while sleeping.
- The battery is recyclable, please follow your local recycling regulations.
- The **LeapPods Max™** headphones include a built-in volume limiter to limit the sound output to 85dBA which is recommended by the World Health Organization. This safety level has been tested for the built-in content and streaming via **Bluetooth®** wireless technology connection.
- When using the line-in connection, some devices may deliver a sound level that exceeds 85dBA. Make sure to always turn the device volume to a low level before placing the headphones on your child's head.

 **Warning!** Continued exposure to loud noise may cause gradual but permanent damage to hearing.

 **WARNING:** For the purposes of recharging the battery, we recommend to use 5V 1A AC/DC adaptor.



Safety information when using power supply for toys

Recommending a power supply (AC/DC adaptor) of the below specification:

Power rating: 5V 1A USB adaptor.

- This toy shall only be used with a power supply for toys.
- The power supply is not a toy.
- This toy is not intended for use by children under 3 years old.
- Do not connect the toy to more than the recommended number of power supplies.
- Never clean a plugged in toy with liquid.
- Please examine the power supply periodically for conditions that may result in the risk of fire, electric shock, or injury to persons (such as damage to the supply cord, output cord, plug, blades, housing, or other parts) and that, in the event of such conditions, the power supply should be scrapped.
- Power supplies for toys are not intended to be used as toys, and the use of these products by children shall be under the full supervision of parents.
- Connecting an AC adaptor to a wall outlet should only be performed by an adult or a supervised child 8+ years of age.
- Never use more than one adaptor.
- Do not connect or disconnect with wet hands.
- This toy shall be used with the power supply supplied, if the power supply is supplied with the toy.
- If the pins of the plug are damaged, the plug-in power supply should be scrapped.
- Do not use if the **Micro-USB Cable** is damaged.

Avoid use in the following conditions:

- Extreme high or low temperatures during use, storage or transportation.
- Low air pressure at high altitude.
- Disposal of the product into fire or a hot oven, or mechanically crushing or cutting the battery, which can result in an explosion.
- Extremely high temperature and/or extremely low air pressure that can result in an explosion or the leakage of flammable liquid or gas.

Environmental Phenomena

Static electricity may cause the unit to malfunction. In cases where unit is malfunctioning due to static electricity, reset the unit by turning the power Off and back On again.

Disclaimer and Limitation of Liability

LeapFrog and its suppliers assume no responsibility for any damage or loss resulting from the use of this handbook. LeapFrog and its suppliers assume no responsibility for any loss or claims by third parties that may arise through the use of this product.

TROUBLESHOOTING

If for some reason the headphones do not work, please follow these steps:

Problem	Correction
The LeapPods Max™ has stopped working	<ol style="list-style-type: none">1. Slide the On/Off Switch to the Off position for 30 seconds.2. Slide the On/Off Switch to the On position again. It should now work properly.3. If the headphones don't work, recharge the battery and repeat steps 1 and 2. (Refer to the Getting Started section for details).

<p>Cannot connect with 3.5mm Audio Cable (not included)</p>	<ol style="list-style-type: none"> 1. Make sure the headphones are powered on. 2. Make sure the cable is a 3.5mm Audio Cable (not included). 3. Check that the 3.5mm Audio Cable (not included) is connected to your headphones and the external device correctly. 4. Inspect the 3.5mm Audio Cable (not included) for damage.
<p>Charging Indicator flashes rapidly while charging</p>	<ol style="list-style-type: none"> 1. Disconnect from power by unplugging the Micro-USB Cable. 2. Inspect the Micro-USB Cable for damage. 3. Reconnect the cable.
<p>Cannot connect with Bluetooth®</p>	<ol style="list-style-type: none"> 1. On your Bluetooth® device, please go to Bluetooth® settings. If the LeapPods Max™ is found in your list of connected, paired or saved devices, please “forget” or “unpair” it. 2. Then, disable and enable Bluetooth® or restart your device. 3. Turn the LeapPods Max™ off and on and repeat the Bluetooth® wireless technology pairing process.
<p>Cannot control the volume level</p>	<p>LeapPods Max™ cannot control the volume on some external devices. If you do not hear audio, be sure to check the volume setting on both LeapPods Max™ and the external device to be sure they are not set to the lowest volume level.</p>

DECLARATION OF CONFORMITY

Hereby, Leapfrog, a division of VTech Electronics Europe BV, declares that the radio equipment type 6162 is in compliance with Directive 2014/53/EU. The full text of the EU declaration of conformity is available at the following internet address : www.leapfrog.com/en-gb/legal/eudoc

Frequency Band: 2401MHz - 2483.5MHz

Maximum RF power: 1m W (0 dBm)

Hereby, Leapfrog, a division of VTech Electronics Europe Plc, declares that the radio equipment type 6162 is in compliance with The Radio Equipment Regulations 2017 (2017 No.1206). The full text of the Declaration of conformity is available at the following internet address:

www.leapfrog.com/en-gb/legal/eudoc

Frequency Band: 2401MHz - 2483.5MHz

Maximum RF power: 1m W (0 dBm)

RF Warning Statement

The device has been evaluated to meet general RF exposure requirement. The device can be used in portable exposure condition without restriction.

CONSUMER SERVICES

Creating and developing **LeapFrog®** products is accompanied by a responsibility that we at **LeapFrog®** take very seriously. We make every effort to ensure the accuracy of the information, which forms the value of our products. However, errors sometimes can occur. It is important for you to know that we stand behind our products and encourage you to call our Consumer Services Department with any problems and/or suggestions that you might have. A service representative will be happy to help you.

UK Customers:

Phone: 01702 200244 (from UK) or +44 1702 200244 (outside UK)

Website: www.leapfrog.co.uk/support

Australian Customers:

Phone: 1800 862 155

Website: support.leapfrog.com.au

NZ Customers:

Phone: 0800 400 785

Website: support.leapfrog.com.au

PRODUCT WARRANTY/ CONSUMER GUARANTEES

UK Customers:

Read our complete warranty policy online at leapfrog.com/warranty.

Australian Customers:

VTECH ELECTRONICS (AUSTRALIA) PTY LIMITED –
CONSUMER GUARANTEES

Under the Australian Consumer Law, a number of consumer guarantees apply to goods and services supplied by VTech Electronics (Australia) Pty Limited. Please refer to leapfrog.com/en-au/legal/warranty for further information.



***Visit our website for more
information about our products,
downloads, resources and more.***

leapfrog.com

***Read our complete warranty and
legal policies online at
leapfrog.com/legal***

LeapFrog Enterprises, Inc.,
A subsidiary of VTech Holdings Limited.
TM & © 2022 LeapFrog Enterprises, Inc.
All rights reserved.

The *Bluetooth*® word mark and logos are registered trademarks owned by the Bluetooth SIG, Inc. and any use of such marks by LeapFrog is under license. Other trademarks and trade names are those of their respective owners.

IM-616200-001
Version:O 