

nickelodeon



Instruction Manual

# The Big Book of PAW Patrol



© 2023 Spin Master PAW Productions Inc. All Rights Reserved. PAW Patrol and all related titles, logos and characters are trademarks of Spin Master Ltd. Nickelodeon and all related titles and logos are trademarks of Viacom International Inc.

# INTRODUCTION

Thank you for purchasing **The Big Book of PAW Patrol**.

**The Big Book of PAW Patrol** features 14 illustrated interactive pages and four fun-packed learning modes. Read about PAW Patrol and explore words, letters and music.



① Light-Up Buttons

② Chase Button

③ Letter Mode Button

④ On/Off Button

⑤ Volume Button

⑥ Marshall Button

⑦ Reading Mode Button

⑧ Skye Button

⑨ Music Mode Button

⑩ Rubble Button

⑪ Find It Mode Button

⑫ Book Pages

# INCLUDED IN THE PACKAGE

- The Big Book of PAW Patrol Book
- Quick Start Guide

## **WARNING:**

All packing materials such as tape, plastic sheets, packaging locks, removable tags, cable ties, cords and packaging screws are not part of this toy, and should be discarded for your child's safety.

## **NOTE:**

Please keep this Instruction Manual as it contains important information.

## **ATTENTION :**

Pour la sécurité de votre enfant, débarrassez-vous de tous les produits d'emballage tels que rubans adhésifs, feuilles de plastique, attaches, étiquettes, cordons et vis d'emballage. Ils ne font pas partie du jouet.

## **NOTE :**

Il est conseillé de conserver ce guide des parents car il comporte des informations importantes.

## **Unlock the Packaging Locks**

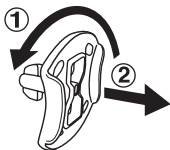

- ① Rotate the packaging locks 90 degrees counterclockwise.
- ② Pull out the packaging locks and discard.

# INSTRUCTIONS

## **WARNING:**

Adult assembly required for battery installation.  
Keep batteries out of reach of children.

## **ATTENTION :**

Les piles ou accumulateurs doivent être installés par un adulte. Tenir les piles ou accumulateurs hors de portée des enfants.

## BATTERY REMOVAL AND INSTALLATION

1. Make sure the unit is turned **Off**.
2. Find the battery cover located on the back of the unit, use a screwdriver to loosen the screw and then open the battery cover.
3. Remove old batteries by pulling up on one end of each battery.
4. Install 3 new AA (LR6/AM-3) batteries following the diagram inside the battery box. (For best performance, alkaline batteries or fully charged Ni-MH rechargeable batteries are recommended).
5. Replace the battery cover and tighten the screw to secure.

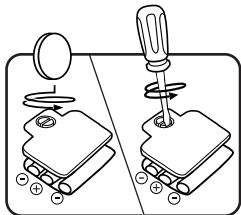

## **IMPORTANT: BATTERY INFORMATION**

- Insert batteries with the correct polarity (+ and -).
- Do not mix old and new batteries.
- Do not mix alkaline, standard (carbon-zinc) or rechargeable batteries.
- Only batteries of the same or equivalent type as recommended are to be used.
- Do not short-circuit the supply terminals.
- Remove batteries during long periods of non-use.
- Remove exhausted batteries from the toy.
- Dispose of batteries safely. Do not dispose of batteries in fire.

## **RECHARGEABLE BATTERIES**

- Remove rechargeable batteries (if removable) from the toy before charging.
- Rechargeable batteries are only to be charged under adult supervision.
- Do not charge non-rechargeable batteries.

## **IMPORTANT : INFORMATIONS CONCERNANT LES PILES**

Les piles fournies avec le produit permettent de tester le jouet en magasin mais ne sont pas des piles longue durée.

- Mettre en place les piles ou les accumulateurs en respectant les polarités + et -.
- Ne pas mélanger des piles ou des accumulateurs neufs avec des usagés.
- Ne pas mélanger différents types de piles : alcalines, zinc-carbone et rechargeables.
- Seules des piles du type recommandé doivent être utilisées.
- Ne pas mettre les bornes d'une pile ou d'un accumulateur en court-circuit (en reliant directement le + et le -).

- Retirer les piles ou les accumulateurs en cas de non-utilisation prolongée.
- Enlever les piles ou les accumulateurs usagés du jouet.
- Ne les jeter ni au feu ni dans la nature.

### **PILES RECHARGEABLES**

- Enlever, lorsque c'est possible, les accumulateurs du jouet pour les recharger.
- Les accumulateurs ne doivent être chargés que sous la surveillance d'un adulte.
- Ne pas tenter de recharger des piles non rechargeables.

### **Note:**

If the unit repeatedly powers down while playing or the light fades out, we suggest changing the batteries.

## **PRODUCT FEATURES**

### **1. On/Off Button**

Press the **On/Off Button** to turn the unit On. To turn the unit Off, press the **On/Off Button** again.



### **2. Volume Button**

Press the **Volume Button** repeatedly to adjust the volume (3 levels).

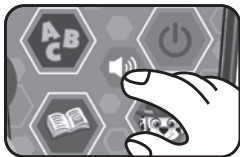

### 3. Letter Mode Button

In Letter mode, turn to the different pages and then press the **Light-Up Buttons** to explore letter names, letter sounds and words.



### 4. Reading Mode Button

In Reading mode, turn to the different pages and press the **Light-Up Buttons** to hear sentences about different PAW Patrol scenes and adventures.



### 5. Music Mode Button

In Music mode, turn to the different pages and press the **Light-Up Buttons** to hear different melodies and sound effects.



### 6. Find It Mode Button

In Find It mode, listen to questions about words, phonics and PAW Patrol events and press the matching **Light-Up Button**.



## 7. Character Buttons

Press the **Marshall, Skye and Rubble Buttons** to hear Chase talk about them.



## 8. Chase Button

Press the **Chase Button** to hear Chase's catchphrases.



## 9. Four Light-Up Buttons

Press the colorful **Light-Up Buttons** to play games and hear phrases from characters. The lights flash with sounds and music.



## 10. 14 Book Pages

Turn to any page to explore letters, phonics, words, sentences and music in different game modes.



## 11. Automatic Shut-Off

To preserve battery life, the unit will automatically power off after about 2 minutes without input. The unit can be turned on again by pressing the **On/Off Button**.



## Note:

If the unit repeatedly powers down while playing or the light fades out, we suggest changing the batteries.

## CARE & MAINTENANCE

1. Keep the unit clean by wiping it with a slightly damp cloth.
2. Keep the unit out of direct sunlight and away from any direct heat sources.
3. Remove the batteries if the unit will not be in use for an extended period of time.
4. Do not drop the unit on hard surfaces and do not expose the unit to moisture or water.

## TROUBLESHOOTING

If for some reason the unit stops working or malfunctions, please follow these steps:

1. Turn the unit **Off**.
2. Interrupt the power supply by removing the batteries.
3. Let the unit stand for a few minutes, then replace the batteries.
4. Turn the unit **On**. The unit should now be ready to use again.
5. If the unit still does not work, install a new set of batteries.

**IMPORTANT NOTE:**

If the problem persists, please call our **Consumer Services Department** at **1-800-701-5327** in the U.S. and Canada, or email **support@leapfrog.com**. Creating and developing LeapFrog products is accompanied by a responsibility that we take very seriously. We make every effort to ensure the accuracy of the information, which forms the value of our products. However, errors sometimes can occur. It is important for you to know that we stand behind our products and encourage you to contact us with any problems and/or suggestions you might have. A service representative will be happy to help you.

**NOTE**

This equipment has been tested and found to comply with the limits for a Class B digital device, pursuant to Part 15 of the FCC Rules. These limits are designed to provide reasonable protection against harmful interference in a residential installation. This equipment generates, uses and can radiate radio frequency energy and, if not installed and used in accordance with the instructions, may cause harmful interference to radio communications. However, there is no guarantee that interference will not occur in a particular installation. If this equipment does cause harmful interference to radio or television reception, which can be determined by turning the equipment off and on, the user is encouraged to try to correct the interference by one or more of the following measures:

- Reorient or relocate the receiving antenna.
- Increase the separation between the equipment and receiver.
- Connect the equipment into an outlet on a circuit different from that to which the receiver is connected.
- Consult the dealer or an experienced radio/TV technician for help.

## CAUTION

Changes or modifications not expressly approved by the party responsible for compliance could void the user's authority to operate the equipment.

### **Supplier's Declaration of Conformity** **47 CFR § 2.1077 Compliance Information**

Trade Name:	LeapFrog®
Model:	6181
Product Name:	PAW Patrol The Big Book of PAW Patrol
Responsible Party:	LeapFrog Enterprises, Inc.
Address:	2200 Powell Street, Suite 500, Emeryville, CA 94608
Website:	leapfrog.com

THIS DEVICE COMPLIES WITH PART 15 OF THE FCC RULES. OPERATION IS SUBJECT TO THE FOLLOWING TWO CONDITIONS: (1) THIS DEVICE MAY NOT CAUSE HARMFUL INTERFERENCE, AND (2) THIS DEVICE MUST ACCEPT ANY INTERFERENCE RECEIVED, INCLUDING INTERFERENCE THAT MAY CAUSE UNDESIRE OPERATION.

CAN ICES-003(B)/NMB-003(B)

## **CONSUMER SERVICES**

Creating and developing VTech® products is accompanied by a responsibility that we at VTech® take very seriously. We make every effort to ensure the accuracy of the information, which forms the value of our products. However, errors sometimes can occur. It is important for you to know that we stand behind our products and encourage you to call our Consumer Services Department with any problems and/or suggestions that you might have. A service representative will be happy to help you.

Australian Customers:

Phone: 1800 862 155

Website: [support.vtech.com.au](http://support.vtech.com.au)

NZ Customers:

Phone: 0800 400 785

Website: [support.vtech.com.au](http://support.vtech.com.au)

## **PRODUCT WARRANTY/ CONSUMER GUARANTEES**

Australian Customers:

**VTECH ELECTRONICS (AUSTRALIA) PTY LIMITED -  
CONSUMER GUARANTEES**

Under the Australian Consumer Law, a number of consumer guarantees apply to goods and services supplied by VTech Electronics (Australia) Pty Limited. Please refer to [vtech.com.au/consumerguarantees](http://vtech.com.au/consumerguarantees) for further information.



**Visit our website for more  
information about our products,  
downloads, resources and more.**

***leapfrog.com***

***leapfrog.ca***

***leapfrog.com.au***

**Read our complete warranty policy online at  
*leapfrog.com/legal***

LeapFrog Enterprises, Inc.,  
A subsidiary of VTech Holdings Limited.  
TM & © 2023 LeapFrog Enterprises, Inc.  
All rights reserved.

**Printed in China**

IM-618100-000

Version:0