



Level Up & Learn Controller™



Parent's Guide

This guide contains important information. Please keep it for future reference.

91-003770-004 UK

INTRODUCTION

Thank you for purchasing the **Level Up & Learn Controller™**!

Explore sounds, songs and 13 activities that teach core learning skills including numbers, shapes, animals, fine motor skills and pretend play.

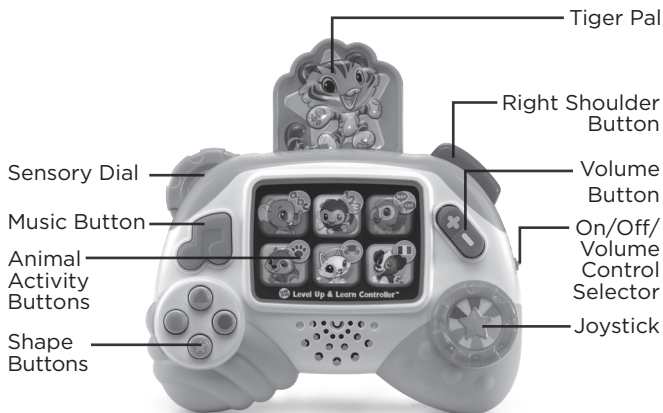

INCLUDED IN THIS PACKAGE

- One **Level Up & Learn Controller™**
- One parent's guide

WARNING:

All packing materials, such as tape, plastic sheets, wire ties and tags are not part of this toy, and should be discarded for your child's safety.

NOTE:

Please keep this parent's guide as it contains important information.

Unlock the packaging locks:

- ① Turn the packaging lock anticlockwise several times.
- ② Pull out and discard the packaging lock.

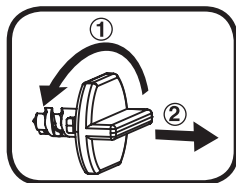

GETTING STARTED

Battery Removal and Installation

1. Make sure the unit is turned **Off**.
2. Locate the battery cover on the back of the unit and use a screwdriver to loosen the screw and open the battery cover.
3. Remove the old batteries by pulling up on one end of each battery.
4. Install 2 new AAA batteries following the diagram inside the battery box. (The use of new alkaline batteries is recommended for maximum performance).
5. Replace the battery cover and tighten the screw to secure.

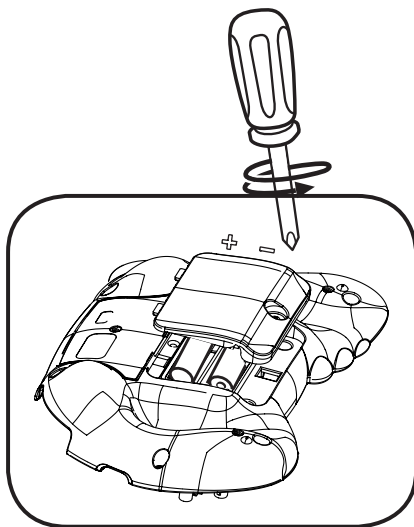

BATTERY NOTICE

- Alkaline batteries are recommended.
- Use only batteries of the same or equivalent type as recommended.
- Do not mix different types of batteries: alkaline, standard (carbon-zinc) or rechargeable, or new and used batteries.
- Do not use damaged batteries.
- Insert batteries with the correct polarity.
- Do not short-circuit the battery terminals.
- Remove exhausted batteries from the toy.
- Remove batteries during long periods of non-use.
- Do not dispose of batteries in fire.
- Do not charge non-rechargeable batteries.
- Remove rechargeable batteries from the toy before charging (if removable).
- Rechargeable batteries are only to be charged under adult supervision.

Disposal of Batteries and Product

The crossed-out wheelie bin symbols on products and batteries, or on their respective packaging, indicates they must not be disposed of in domestic waste as they contain substances that can be damaging to the environment and human health.



The chemical symbols Hg, Cd or Pb, where marked, indicate that the battery contains more than the specified value of mercury (Hg), cadmium (Cd) or lead (Pb) set out in Battery Directive (2006/66/EC).



The solid bar indicates that the product was placed on the market after 13th August, 2005.

Help protect the environment by disposing of your product or batteries responsibly.

For more information, please visit:

www.recycle-more.co.uk

www.recyclenow.com

PRODUCT FEATURES

1. On/Off/Volume Control Selector

Slide the **On/Off/Volume Control Selector** to turn the toy on and select the volume.



2. Tiger Pal

Push **Tiger** into the controller until she clicks into place. Then press the **Right Shoulder Button** to activate the peek-a-boo action. Periodically, **Tiger** will pop out and trigger a fun bonus game that asks the child to answer questions by pressing the correct animal buttons.

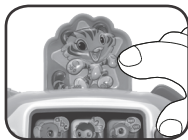

3. Sensory Dial

Spin this non-electronic **Sensory Dial** to develop fine motor skills.



4. Right Shoulder Button

When **Tiger** is inside the controller, press the **Right Shoulder Button** to trigger the peek-a-boo action.

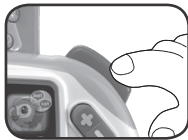

5. Music Button

Press to hear three learning songs and one fun dance track.

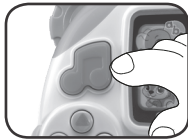

6. Animal Activity Buttons

Elephant

Touch 1: Plays ABC song.

Touch 2: Activates ABC activity.

Monkey

Touch 1: Plays Number song.

Touch 2: Activates counting activity.

Parrot

Touch to hear fun rhymes.

Squirrel

Touch to play an animal identification activity.

Cat

Touch the cat, then the next ten touches (of any button or manipulative) will play fun video game sounds.

Dog

Touch to learn simple French phrases.



7. Volume Button

Press to increase or decrease the volume of silly phrases and animal sounds.

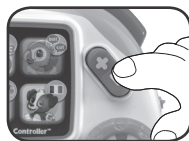

8. Shape Buttons

Press to hear fun phrases about shapes and colours. Different button combinations (e.g., pressing a shape button, then a non-shape button, then a shape button again) unlock special bonus activities.



9. Joystick

Move the **Joystick** up, down, left and right to hear animal names and sounds. Different button combinations (e.g., pressing the joystick, then any button, then the joystick again) unlock a special counting activity.

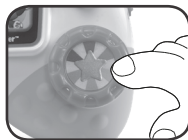

10. Automatic Shut Off

To preserve battery life, the **Level Up & Learn Controller™** will automatically shut off after approximately 60 seconds without input. The unit can be turned on again by pressing any button.

NOTE:

If the unit powers down or if the light fades out during play, please install a new set of batteries.



CARE & MAINTENANCE

1. Keep the unit clean by wiping it with a slightly damp cloth.
2. Keep the unit out of direct sunlight and away from any direct heat source.
3. Remove the batteries when the unit will not be in use for an extended period of time.
4. Do not drop the unit on hard surfaces and do not expose the unit to moisture or water.

TROUBLESHOOTING

If for some reason the unit stops working or malfunctions, please follow these steps:

1. Please turn the unit **Off**.
2. Interrupt the power supply by removing the batteries.
3. Let the unit stand for a few minutes, then replace the batteries.
4. Turn the unit **On**. The unit will now be ready to use again.
5. If the unit still does not work, install a brand new set of batteries.

Caution:

Changes or modifications not expressly approved by the party responsible for compliance could void the user's authority to operate the equipment.

Environmental Phenomena

The unit may malfunction if subjected to radio-frequency interference. It should revert to normal operation when the interference stops. If not, it may become necessary to turn the power **Off** and back **On**, or remove and reinstall the batteries. In the unlikely event of an electrostatic discharge, the unit may malfunction and lose memory, requiring the user to reset the device by removing and reinstalling the batteries.



CLASS 1
LED PRODUCT



CONSUMER SERVICES

We stand behind our products and encourage you to call our Consumer Services Department with any problems and/or suggestions that you might have. A service representative will be happy to help you.

UK Customers:

Phone: 01702 200244 (from UK) or +44 1702 200244 (outside UK)

Website: www.leapfrog.co.uk/support

Australian Customers:

Phone: 1800 862 155

Website: support.leapfrog.com.au

NZ Customers:

Phone: 0800 400 785

Website: support.leapfrog.com.au

PRODUCT WARRANTY/ CONSUMER GUARANTEES

UK Customers:

Read our complete warranty policy online at leapfrog.com/warranty.

Australian Customers:

VTECH ELECTRONICS (AUSTRALIA) PTY LIMITED -
CONSUMER GUARANTEES

Under the Australian Consumer Law, a number of consumer guarantees apply to goods and services supplied by VTech Electronics (Australia) Pty Limited. Please refer to leapfrog.com/en-au/legal/warranty for further information.



***Visit our website for more
information about our products,
downloads, resources and more.***

***leapfrog.com
leapfrog.com.au***

LeapFrog Enterprises, Inc.
A subsidiary of VTech Holdings Limited.
TM & © 2019 LeapFrog Enterprises, Inc.
All rights reserved.
91-003770-004 UK