



Yum-2-3 Toaster™



Parent's Guide

This guide contains important information. Please keep it for future reference.

91-003780-002 US

INTRODUCTION

Thank you for purchasing the **Yum-2-3 Toaster™!**

Prepare a pretend breakfast and serve up learning activities that encourage pretend play. Numbers, counting, colors and opposites are reinforced with sounds, phrases, songs and a light-up mouth on the pretend toaster's face.

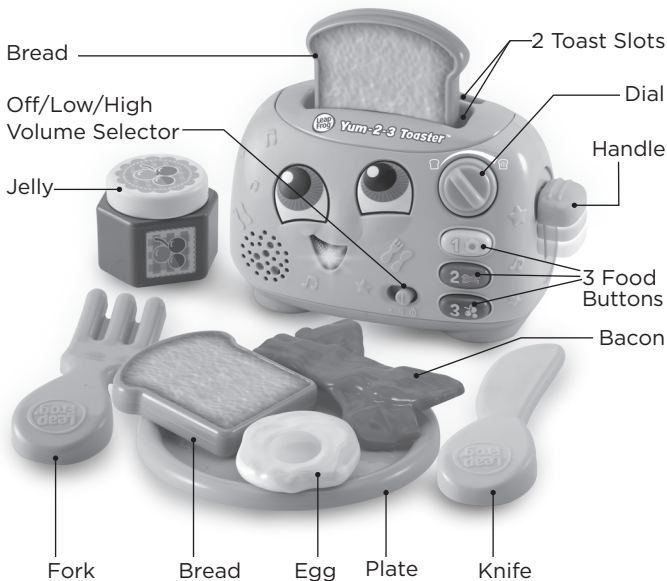

INCLUDED IN THIS PACKAGE

- Yum-2-3 Toaster™
- 1 fork, 1 knife and 1 plate



- 6 play food pieces

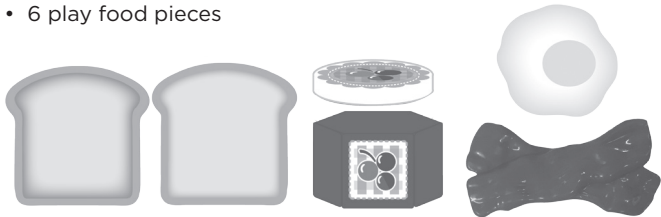

- Parent's guide

WARNING:

All packing materials such as tape, plastic sheets, packaging locks, removable tags, cable ties, cord and packaging screws are not part of this toy, and should be discarded for your child's safety.

NOTE:

Please keep this parent's guide as it contains important information.

ATTENTION :

Pour la sécurité de votre enfant, débarrassez-vous de tous les produits d'emballage tels que rubans adhésifs, feuilles de plastique, attaches, étiquettes et vis d'emballage. Ils ne font pas partie du jouet.

NOTE :

Il est conseillé de conserver ce guide des parents car il comporte des informations importantes.

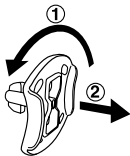
Unlock the Packaging Locks

- ① Rotate the packaging lock 90 degrees counterclockwise.

- ② Pull out the packaging lock and discard.

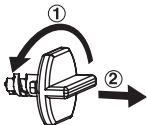

- ① Turn the packaging lock counterclockwise several times.

- ② Pull out the packaging lock and discard.

GETTING STARTED

Battery Removal and Installation

1. Make sure the unit is turned **Off**.
2. Find the battery cover on the back of the unit and use a screwdriver to loosen the screw and open the battery cover.
3. Remove the old batteries by pulling up on one end of each battery.
4. Install 2 new AAA batteries following the diagram inside the battery box.
5. Replace the battery cover and tighten the screw to secure.

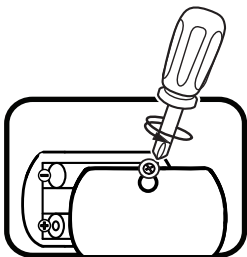

BATTERY NOTICE

- Use new alkaline batteries for maximum performance.
- Use only batteries of the same or equivalent type as recommended.
- Do not mix different types of batteries: alkaline, standard (carbon-zinc) or rechargeable, or new and used batteries.
- Do not use damaged batteries.
- Insert batteries with the correct polarity (+ and -).
- Do not short-circuit the battery terminals.
- Remove exhausted batteries from the toy.
- Remove batteries during long periods of non-use.
- Do not dispose of batteries in fire.
- Do not charge non-rechargeable batteries.
- Remove rechargeable batteries from the toy before charging (if removable).
- Rechargeable batteries are only to be charged under adult supervision.

MISE EN GARDE

- Utiliser des piles alcalines neuves pour des performances maximales.
- Seules des piles du type recommandé doivent être utilisées.
- Ne pas mélanger différents types de piles ou d'accumulateurs, ne pas mélanger des piles ou des accumulateurs neufs avec des usagés.
- Ne pas utiliser des piles ou des accumulateurs endommagés.
- Mettre en place les piles ou les accumulateurs en respectant les polarités + et -.
- Ne pas mettre les bornes d'une pile ou d'un accumulateur en court-circuit (en reliant directement le + et le -).
- Enlever les piles ou les accumulateurs usagés du jouet.
- Retirer les piles ou les accumulateurs en cas de non-utilisation prolongée.
- Ne les jeter ni au feu ni dans la nature.
- Ne pas tenter de recharger des piles non rechargeables.
- Enlever les accumulateurs du jouet pour les recharger.
- Les accumulateurs ne doivent être chargés que sous la surveillance d'un adulte.

PRODUCT FEATURES

1. Off/Low/High Volume Selector

To turn the unit **On**, slide the **Off/Low/High Volume Selector** to the **Low** » or **High** » position. To turn the unit **Off**, slide the **Off/Low/High Volume Selector** to the **Off** ● position.



2. 1-2-3 Food Buttons

Press the **Food Buttons** to hear interesting sounds, phrases, sing-along songs about numbers and counting, colors, foods and making breakfast.



3. Toast Dial

Turn the **Dial** to the left or right to choose between **Light Toast** and **Dark Toast** and hear fun phrases and sounds.



4. Toast Slots

Insert the **Bread** pieces into the **Toast Slots** and press down to hear fun sounds, phrases and sing-along songs about numbers and toast.



5. Pop-Up Handle

When the toast is ready, press down on the **Handle** to pop out the toast and hear fun sounds, phrases and sing-along songs.



6. Automatic Shut-Off

To preserve battery life, the **Yum-2-3 Toaster™** will automatically shut off after approximately 65 seconds without input. The unit can be turned on again by pressing any button, inserting the **Bread** into the toaster or turning the **Dial**.

NOTE

Do not place any object into the **Toast Slots** other than the **Bread** pieces provided with the **Yum-2-3 Toaster™**.

NOTE

If the unit powers down or if the light fades out during play, please install a new set of batteries.

ACTIVITIES

1. Pretend to Make Toast

Pretend to cook by placing the **Bread** pieces in the toaster. Take the lid off the **Jelly** and use the **Knife** to pretend to spread **Jelly** on the toast.

2. Pretend to Serve and Eat Meals

Create a pretend meal by using two **Bread** pieces, one **Egg** and two slices of **Bacon** (one play piece). Serve them on the **Plate** and pretend to eat with the **Knife** and **Fork**.

3. Opposites Play

Turn the **Dial** to learn about pairs of opposites like Light Toast/Dark Toast and Short Time/Long Time. Press the **Bread** pieces into the toaster and press down on the **Handle** to learn about the opposite pairs In/Out and Down/Up.

SONG LYRICS

Wake Up Song

Wake up,
Wake up,
Wiggle your toes,
The toast pops up,
And the rooster crows.
Breakfast time,
Is coming your way,
So open up your eyes,
And greet a brand new day.

Light Toast Song

It takes a short time to make light toast,
1, 2, 3,
It takes a short time,
1, 2, 3.

Dark Toast Song

It takes a long time to make dark toast,
1, 2, 3, 4, 5,
It takes a long time,
1, 2, 3, 4, 5.

Big Breakfast Song

Pick up a plate,
It'll be great,
A big breakfast is right around the corner.
One egg, two slices of bacon,
Frying in a pan.
Make the most of your toast,
With some jelly or jam.

CARE & MAINTENANCE

1. Keep the unit clean by wiping it with a slightly damp cloth.
2. Keep the unit out of direct sunlight and away from any direct heat sources.
3. Remove the batteries if the unit will not be in use for an extended period of time.
4. Do not drop the unit on hard surfaces and do not expose the unit to moisture or water.

TROUBLESHOOTING

If for some reason the unit stops working or malfunctions, please follow these steps:

1. Please turn the unit **Off**.
2. Interrupt the power supply by removing the batteries.
3. Let the unit stand for a few minutes, then replace the batteries.
4. Turn the unit **On**. The unit should now be ready to use again.
5. If the unit still does not work, install a new set of batteries.

IMPORTANT NOTE:

If the problem persists, please call our **Consumer Services Department** at **1-800-701-5327** in the U.S. or email **support@leapfrog.com**. Creating and developing LeapFrog® products is accompanied by a responsibility that we take very seriously. We make every effort to ensure the accuracy of the information, which forms the value of our products. However, errors sometimes can occur. It is important for you to know that we stand behind our products and encourage you to contact us with any problems and/or suggestions you might have. A service representative will be happy to help you.

Environmental Phenomena

The unit may malfunction if subjected to radio-frequency interference. It should revert to normal operation when the interference stops. If not, it may become necessary to turn the power **Off** and back **On**, or remove and reinstall the batteries. In the unlikely event of an electrostatic discharge, the unit may malfunction and lose memory, requiring the user to reset the device by removing and reinstalling the batteries.

Impact de l'environnement

Une défaillance de fonctionnement de l'appareil peut survenir s'il est sujet à des interférences avec les fréquences radioélectriques. Le fonctionnement normal de l'appareil devrait reprendre avec l'arrêt des interférences. Si ce n'est pas le cas, il peut s'avérer nécessaire d'éteindre et rallumer l'appareil ou de retirer et réinstaller les piles. Dans l'éventualité peu probable d'une décharge électrostatique, un mauvais fonctionnement et une perte de mémoire de l'appareil peuvent se produire. L'utilisateur doit alors retirer et réinstaller les piles pour réinitialiser l'appareil.

NOTE:

This equipment has been tested and found to comply with the limits for a Class B digital device, pursuant to Part 15 of the FCC Rules. These limits are designed to provide reasonable protection against harmful interference in a residential installation. This equipment generates, uses and can radiate radio frequency energy and, if not installed and used in accordance with the instructions, may cause harmful interference to radio communications. However, there is no guarantee that interference will not occur in a particular installation. If this equipment does cause harmful interference to radio or television reception, which can be determined by turning the equipment off and on, the user is encouraged to try to correct the interference by one or more of the following measures:

- Reorient or relocate the receiving antenna.
- Increase the separation between the equipment and receiver.
- Connect the equipment into an outlet on a circuit different from that to which the receiver is connected.
- Consult the dealer or an experienced radio/TV technician for help.

Supplier's Declaration of Conformity

Trade Name: LeapFrog®
Model: 6098
Product Name: **Yum-2-3 Toaster™**
Responsible Party: LeapFrog Enterprises, Inc.
Address: 6401 Hollis Street, Suite 100,
Emeryville, CA 94608
Website: leapfrog.com

THIS DEVICE COMPLIES WITH PART 15 OF THE FCC RULES.
OPERATION IS SUBJECT TO THE FOLLOWING TWO CONDITIONS:
(1) THIS DEVICE MAY NOT CAUSE HARMFUL INTERFERENCE, AND
(2) THIS DEVICE MUST ACCEPT ANY INTERFERENCE RECEIVED,
INCLUDING INTERFERENCE THAT MAY CAUSE UNDESIRE
OPERATION.

CAN ICES-3 (B)/NMB-3(B)

CAUTION

Changes or modifications not expressly approved by the party responsible for compliance could void the user's authority to operate the equipment.

**CLASS 1
LED PRODUCT**



***Visit our website for more
information about our products,
downloads, resources and more.***

leapfrog.com

***Read our complete warranty policy online at
leapfrog.com/warranty.***

LeapFrog Enterprises, Inc.
A subsidiary of VTech Holdings Limited.
TM & © 2019 LeapFrog Enterprises, Inc.
All rights reserved.
91-003780-002 