



# Yum-2-3 Deluxe Breakfast Set™



## Instruction Manual

This guide contains important information. Please keep it for future reference.  
Ce guide contient des informations importantes. Veuillez le conserver pour toute référence future.

# INTRODUCTION

Thank you for purchasing the **Yum-2-3 Deluxe Breakfast Set™!** Prepare a pretend breakfast and serve up learning activities that encourage pretend play. Numbers, counting, colors and opposites are reinforced with sounds, phrases, songs and a light-up mouth on the pretend toaster's face. With this deluxe set, add fruit, cereal and drinks to breakfast time or serve up pretend meals for two or more.

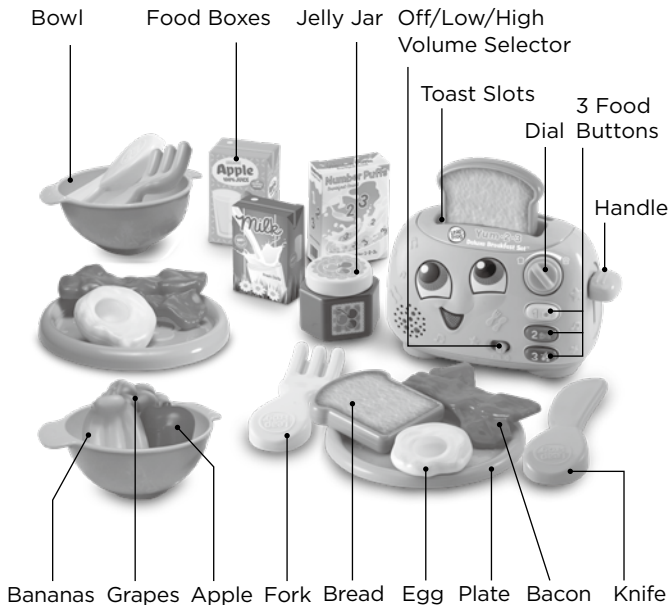

# INCLUDED IN THE PACKAGE



1 toaster

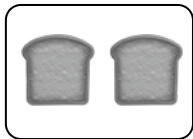

2 slices of bread



3 food boxes



2 eggs



2 bacon stacks



2 bowls



2 plates



2 forks



2 knives



1 grapes



1 apple



1 bananas



1 jelly jar

- Quick Start Guide

## WARNING

All packing materials, including tape, plastic sheets, packaging locks, removable tags, cable ties, cords and packaging screws are not part of this toy, and should be discarded for your child's safety.

## NOTE

Please save this Instruction Manual as it contains important information.

## ATTENTION

Pour la sécurité de votre enfant, débarrassez-vous de tous les produits d'emballage tels que rubans adhésifs, feuilles de plastique, attaches, étiquettes et vis d'emballage. Ils ne font pas partie du jouet.

## NOTE

Il est conseillé de sauvegarder ce manuel d'utilisation car il comporte des informations importantes.

## Unlock the Packaging Locks

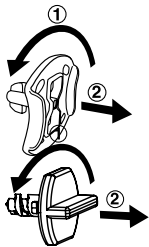

① Rotate the packaging lock 90 degrees counterclockwise.

② Pull out the packaging lock and discard.

① Turn the packaging lock counterclockwise several times.

② Pull out the packaging lock and discard.

# GETTING STARTED

## Battery Removal and Installation

1. Make sure the unit is turned Off.
2. Find the battery cover located on the back of the unit, use a screwdriver to loosen the screw, and then open the battery cover.
3. Remove old batteries by pulling up on one end of each battery.
4. Install 2 new AAA batteries following the diagram inside the battery box. (For best performance, alkaline batteries or fully charged Ni-MH rechargeable batteries are recommended.)
5. Replace the battery cover and tighten the screw to secure.

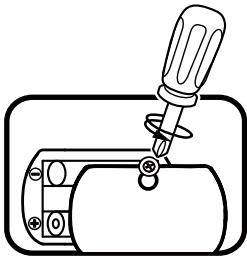

### **WARNING**

Adult assembly needed. Close the battery door and tighten the screw to secure before giving your child the toy.



### **ATTENTION**

L'assemblage doit être effectué par un adulte. Fermer puis revisser fermement le couvercle du compartiment à piles avant de donner ce jouet à un enfant.

## **IMPORTANT: BATTERY INFORMATION**

- Insert batteries with the correct polarity (+ and -).
- Do not mix old and new batteries.
- Do not mix alkaline, standard (carbon-zinc) or rechargeable batteries.
- Only batteries of the same or equivalent type as recommended are to be used.

- Do not short-circuit the supply terminals.
- Remove batteries during long periods of non-use.
- Remove exhausted batteries from the toy.
- Dispose of batteries safely. Do not dispose of batteries in fire.

## **RECHARGEABLE BATTERIES**

- Remove rechargeable batteries (if removable) from the toy before charging.
- Rechargeable batteries are only to be charged under adult supervision.
- Do not charge non-rechargeable batteries.

## **IMPORTANT : INFORMATIONS CONCERNANT LES PILES**

Les piles fournies avec le produit permettent de tester le jouet en magasin mais ne sont pas des piles longue durée.

- Mettre en place les piles ou les accumulateurs en respectant les polarités + et -.
- Ne pas mélanger des piles ou des accumulateurs neufs avec des usagés.
- Ne pas mélanger différents types de piles : alcalines, zinc-carbone et rechargeables.
- Seules des piles du type recommandé doivent être utilisées.
- Ne pas mettre les bornes d'une pile ou d'un accumulateur en court-circuit (en reliant directement le + et le -).
- Retirer les piles ou les accumulateurs en cas de non-utilisation prolongée.
- Enlever les piles ou les accumulateurs usagés du jouet.
- Ne les jeter ni au feu ni dans la nature.

# PRODUCT FEATURES

## 1. Off/Low/High Volume Selector

To turn the unit **On**, slide the **Off/Low/High Volume Selector** to the **Low** » or **High** » position. To turn the unit **Off**, slide the **Off/Low/High Volume Selector** to the **Off** ● position.



## 2. 1-2-3 Food Buttons

Press the **Food Buttons** to hear interesting sounds, phrases and sing-along songs about numbers and counting, colors, foods and making breakfast.

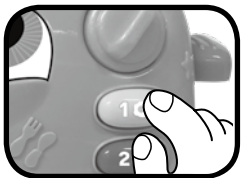

## 3. Toast Dial

Turn the **Dial** to the left or right to choose between light toast and dark toast and hear fun phrases and sounds.



## 4. Toast Slots

Insert the **Bread** slices into the **Toast Slots** and press down to hear fun sounds, phrases and sing-along songs about numbers and toast.



## 5. Pop-Up Handle

When the toast is ready, press down on the **Handle** to pop out the toast and hear fun sounds, phrases and sing-along songs.

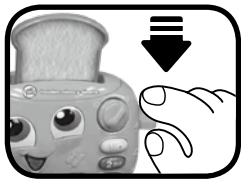

## 6. Automatic Shut-Off

To preserve battery life, the **Yum-2-3 Deluxe Breakfast Set™** will automatically shut off after approximately 65 seconds without input. The unit can be turned on again by pressing any button, inserting the **Bread** into the toaster or turning the **Dial**.

### NOTE

Do not place any object into the **Toast Slots** other than the **Bread** slices provided with the **Yum-2-3 Deluxe Breakfast Set™**.

### NOTE

Prière de ne pas insérer d'autres objets dans la fente du grille pain que ceux inclus dans ce jouet.

### NOTE

If the unit powers down or if the light fades out during play, please install a new set of batteries.

# ACTIVITIES

## 1. Pretend to Make Toast

Pretend to cook by placing the **Bread** slices in the toaster. Take the lid off the **Jelly Jar** and use a **Knife** to pretend to spread jelly on the toast.

## 2. Pretend to Serve and Eat Meals

Create pretend meals for two by using two **Bread** slices, two **Eggs**, two **Bacon** stacks, fruit and food boxes. Serve them on the two **Plates** or in the two **Bowls** and pretend to eat with the two **Knives** and two **Forks**.



### 3. Opposites Play

Turn the **Dial** to learn about pairs of opposites like Light Toast/Dark Toast and Short Time/Long Time. Press the **Bread** slices into the toaster and press down on the **Handle** to learn about the opposite pairs In/Out and Down/Up.

## SONG LYRICS

### Wake Up Song

Wake up,  
Wake up,  
Wiggle your toes,  
The toast pops up,  
And the rooster crows.  
Breakfast time,  
Is coming your way,  
So open up your eyes,  
And greet a brand new day.

### Light Toast Song

It takes a short time to make light toast,  
1, 2, 3,  
It takes a short time,  
1, 2, 3.

### Dark Toast Song

It takes a long time to make dark toast,  
1, 2, 3, 4, 5,  
It takes a long time,  
1, 2, 3, 4, 5.

## Big Breakfast Song

Pick up a plate,  
It'll be great,  
A big breakfast is right around the corner.  
One egg, two slices of bacon,  
Frying in a pan.  
Make the most of your toast,  
With some jelly or jam.

## CARE & MAINTENANCE

1. Keep the unit clean by wiping it with a slightly damp cloth.
2. Keep the unit out of direct sunlight and away from any direct heat sources.
3. Remove the batteries if the unit will not be in use for an extended period of time.
4. Do not drop the unit on hard surfaces and do not expose the unit to moisture or water.

## TROUBLESHOOTING

If for some reason the unit stops working or malfunctions, please follow these steps:

1. Please turn the unit **Off**.
2. Interrupt the power supply by removing the batteries.
3. Let the unit stand for a few minutes, then replace the batteries.
4. Turn the unit **On**. The unit should now be ready to use again.
5. If the unit still does not work, install a new set of batteries.

### **IMPORTANT NOTE:**

If the problem persists, please call our Consumer Services Department at **1-800-701-5327** in the U.S. or email [support@leapfrog.com](mailto:support@leapfrog.com). Creating and developing LeapFrog® products is accompanied by a responsibility that we take very seriously. We make every effort to ensure the accuracy of the information, which forms the value of our products. However, errors sometimes can occur. It is important for you to know that we stand behind our products and encourage you to contact us with any problems and/or suggestions you might have. A service representative will be happy to help you.

## **Environmental phenomena**

The unit may malfunction if subjected to radio-frequency interference. It should revert to normal operation when the interference stops. If not, it may become necessary to turn the power Off and back On, or remove and reinstall the batteries. In the unlikely event of an electrostatic discharge, the unit may malfunction and lose memory, requiring the user to reset the device by removing and reinstalling the batteries.

## **Impact de l'environnement**

Une défaillance de fonctionnement de l'appareil peut survenir s'il est sujet à des interférences avec les fréquences radioélectriques. Le fonctionnement normal de l'appareil devrait reprendre avec l'arrêt des interférences. Si ce n'est pas le cas, il peut s'avérer nécessaire d'éteindre et rallumer l'appareil ou de retirer et réinstaller les piles. Dans l'éventualité peu probable d'une décharge électrostatique, un mauvais fonctionnement et une perte de mémoire de l'appareil peuvent se produire. L'utilisateur doit alors retirer et réinstaller les piles pour réinitialiser l'appareil.

## NOTE:

This equipment has been tested and found to comply with the limits for a Class B digital device, pursuant to Part 15 of the FCC Rules. These limits are designed to provide reasonable protection against harmful interference in a residential installation. This equipment generates, uses and can radiate radio frequency energy and, if not installed and used in accordance with the instructions, may cause harmful interference to radio communications. However, there is no guarantee that interference will not occur in a particular installation. If this equipment does cause harmful interference to radio or television reception, which can be determined by turning the equipment off and on, the user is encouraged to try to correct the interference by one or more of the following measures:

- Reorient or relocate the receiving antenna.
- Increase the separation between the equipment and receiver.
- Connect the equipment into an outlet on a circuit different from that to which the receiver is connected.
- Consult the dealer or an experienced radio/TV technician for help.

**Caution:** Changes or modifications not expressly approved by the party responsible for compliance could void the user's authority to operate the equipment.

## Supplier's Declaration of Conformity

Trade Name: LeapFrog®  
Model: 6098  
Product Name: Yum-2-3 Deluxe Breakfast Set™  
Responsible Party: LeapFrog Enterprises, Inc.  
Address: 2200 Powell Street, Suite 500,  
Emeryville, CA 94608  
Website: leapfrog.com

THIS DEVICE COMPLIES WITH PART 15 OF THE FCC RULES. OPERATION IS SUBJECT TO THE FOLLOWING TWO CONDITIONS: (1) THIS DEVICE MAY NOT CAUSE HARMFUL INTERFERENCE, AND (2) THIS DEVICE MUST ACCEPT ANY INTERFERENCE RECEIVED, INCLUDING INTERFERENCE THAT MAY CAUSE UNDESIRE OPERATION.  
CAN ICES-003(B)/NMB-003(B)



***Visit our website for more  
information about our products,  
downloads, resources and more.***

***leapfrog.com***  
***leapfrog.ca***

Read our complete warranty and legal policies  
online at [leapfrog.com/warranty](http://leapfrog.com/warranty)

LeapFrog Enterprises, Inc.  
A subsidiary of VTech Holdings Limited.  
TM & © 2022 LeapFrog Enterprises, Inc.  
All rights reserved.  
IM-609860-000