



# Purrfect Counting Handbag



## Parent's Guide

This guide contains important information. Please keep it for future reference.

91-003830-001 UK

# INTRODUCTION

Thank you for purchasing the **Purrfect Counting Handbag**.

This clever kitten handbag teaches numbers, counting, shapes and colours while promoting imaginary play with three ways to play. The five play accessories match the light-up buttons on the interactive tiara so children can pack up the handbag for on-the-go fun while improving their fine and gross motor skills.

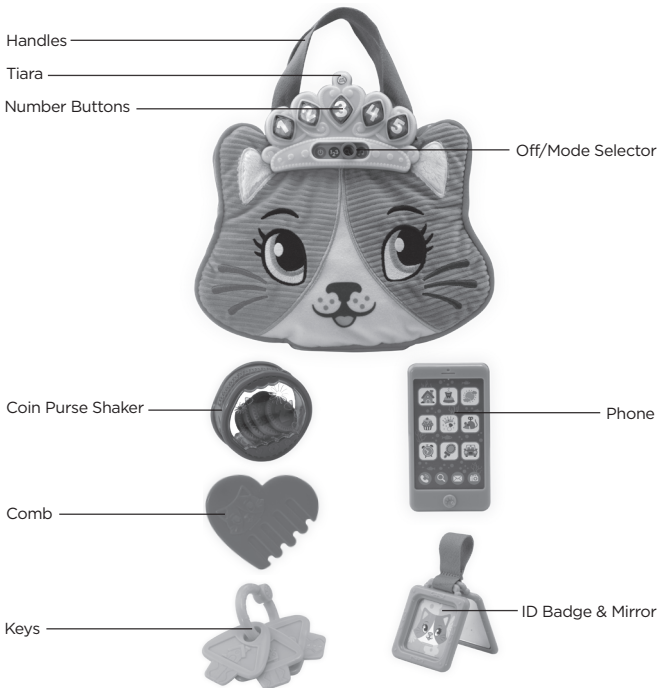

## INCLUDED IN THIS PACKAGE

- **Purrfect Counting Handbag**
- 5 play accessories
  - Phone
  - ID badge & mirror
  - Keys
  - Comb
  - Coin purse shaker
- Parent's guide

### WARNING

All packing materials, such as tape, plastic sheets, packaging locks, removable tags, cable ties and packaging screws are not part of this toy, and should be discarded for your child's safety.

### NOTE

Please keep this parent's guide as it contains important information.

### Unlock the packaging locks:

- ① Turn the packaging lock anti-clockwise several times.
- ② Pull out and discard the packaging lock.

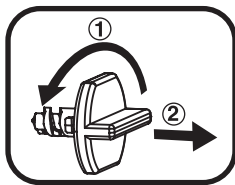

# GETTING STARTED

## BATTERY REMOVAL AND INSTALLATION

1. Make sure the unit is turned **Off**.
2. Find the battery cover located on the back of the unit and use a screwdriver to loosen the screw and open the battery cover.
3. Remove old batteries by pulling up on one end of each battery.
4. Install 2 new AAA (AM-4/LR03) batteries into the battery compartment as illustrated.
5. Replace the battery cover and tighten the screw to secure.

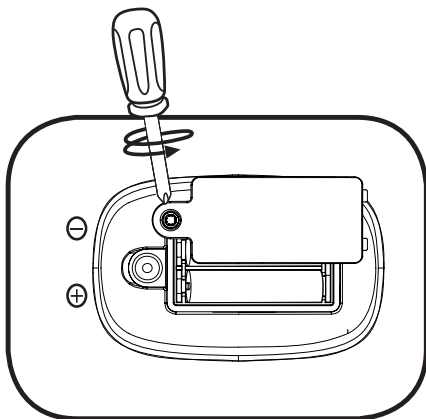

## BATTERY NOTICE

- Alkaline batteries are recommended.
- Use only batteries of the same or equivalent type as recommended.
- Do not mix different types of batteries: alkaline, standard (carbon-zinc) or rechargeable, or new and used batteries.
- Do not use damaged batteries.
- Insert batteries with the correct polarity.
- Do not short-circuit the battery terminals.
- Remove exhausted batteries from the toy.
- Remove batteries during long periods of non-use.
- Do not dispose of batteries in fire.
- Do not charge non-rechargeable batteries.
- Remove rechargeable batteries from the toy before charging (if removable).
- Rechargeable batteries are only to be charged under adult supervision.

## Disposal of Batteries and Product



The crossed-out wheeled bin symbols on products and batteries, or on their respective packaging, indicates they must not be disposed of in domestic waste as they contain substances that can be damaging to the environment and human health.



The chemical symbols Hg, Cd or Pb, where marked, indicate that the battery contains more than the specified value of mercury (Hg), cadmium (Cd) or lead (Pb) set out in Battery Directive (2006/66/EC).

The solid bar indicates that the product was placed on the market after 13th August, 2005.





Help protect the environment by disposing of your product or batteries responsibly.

For more information, please visit:

[www.recycle-more.co.uk](http://www.recycle-more.co.uk)  
[www.recyclenow.com](http://www.recyclenow.com)

# PRODUCT FEATURES

## 1. Off/Mode Selector

To turn the unit **On**, slide the **Off/Mode Selector** from the **Off** position to Learn mode , Pretend mode  or Music mode . To turn the unit **Off**, slide the **Off/Mode Selector** to the **Off**  position.



### Learn Mode

Press the light-up number buttons to learn about numbers, counting, shapes and colours.

### Pretend Mode

Press the light-up number buttons to hear fun cat phrases and sounds which spark your child's imagination for pretend play.

### Music Mode

Press the light-up number buttons for 3 unique musical activities.

## 2. Five Light-Up Number Buttons

In Learn and Pretend modes, press the **Number** buttons to hear phrases and sounds related to the matching coloured play accessory. In Music mode, press the light-up **Number** buttons for three musical activities:

- The number 1 button plays three songs to dance and sing along to.
- The number 2, 3 and 4 buttons offer a Jam Along activity. Press the **Number** buttons to add fun sounds to the three different tunes.
- The number 5 button plays a cat piano to create your own music.

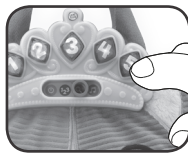

### 3. Two Handles

With the two handles and sturdy construction, the handbag is easy to pack up with the play accessories. Its stand-open construction makes it easy to fill, empty, and fill again while reinforcing fine-motor skills. Carry the handbag around to work gross-motor skills.



### 4. Textured Fabrics

The friendly cat face offers tactile learning with different fabric textures and printed designs.

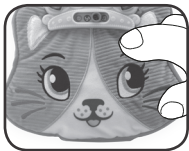

### 5. Automatic Shut-Off

To preserve battery life, the **Purrfect Counting Handbag** will automatically shut off after approximately 60 seconds without input. The unit can be turned on again by pressing any light-up **Number** button or moving the **Off/Mode Selector** to Learn mode, Pretend mode or Music mode.

#### NOTE

If the unit powers down or if the lights fade out during play, please install a new set of batteries.

## ACTIVITIES

### 1. Put-and-Take Play

Fill the stand-open handbag with the five accessories. Empty it and fill it again to refine fine-motor skills. Carrying the handbag around helps develop gross-motor skills.



## **2. Pretend Play**

Pretend to have a busy day out and about with the handbag and five play accessories. Each one has molded numbers and vibrant details to reinforce counting and colour identification in everyday activities.

## **3. Musical Play**

Switch to Music mode to enjoy three musical activities: listening to songs, jamming along to tunes by pressing the number buttons to add fun sounds, and playing a cat piano using the musical scale.

## **4. Sensory Play**

The various fabric textures and details on the handbag provide additional tactile discovery through sensory play.

# **SONG LYRICS**

## **Pack Up Your Handbag Song**

Let's get ready to go.

Grab everything that you need.

Pack up your bag.

Meow!

## **Colourful Things Song**

Bring all our things for a colourful day.

See shapes and colours wherever we play.

Let's play and sing with these colourful things!

## **Counting Song**

1, 2, 3, 4, 5

Do you have everything?





## CARE & MAINTENANCE

1. Keep the unit clean by wiping it with a slightly damp cloth.
2. Keep the unit out of direct sunlight and away from direct heat sources.
3. Remove the batteries if the unit will not be in use for an extended period of time.
4. Do not drop the unit on a hard surface and do not expose the unit to moisture or water.

## TROUBLESHOOTING

If for some reason the unit stops working or malfunctions, please follow these steps:

1. Turn the unit **Off**.
2. Interrupt the power supply by removing the batteries.
3. Let the unit stand for a few minutes, then replace the batteries.
4. Turn the unit **On**. The unit should now be ready to use again.
5. If the unit still does not work, install a new set of batteries.

## Environmental Phenomena

The unit may malfunction if subjected to radio-frequency interference. It should revert to normal operation when the interference stops. If not, it may become necessary to turn the power **Off** and back **On**, or remove and reinstall the batteries. In the unlikely event of an electrostatic discharge, the unit may malfunction and lose memory, requiring the user to reset the device by removing and reinstalling the batteries.



## CONSUMER SERVICES

We stand behind our products and encourage you to call our Consumer Services Department with any problems and/or suggestions that you might have. A service representative will be happy to help you.

### **UK Customers:**

Phone: 01702 200244 (from UK) or +44 1702 200244 (outside UK)

Website: [www.leapfrog.co.uk/support](http://www.leapfrog.co.uk/support)

### **Australian Customers:**

Phone: 1800 862 155

Website: [support.leapfrog.com.au](http://support.leapfrog.com.au)

### **NZ Customers:**

Phone: 0800 400 785

Website: [support.leapfrog.com.au](http://support.leapfrog.com.au)

## PRODUCT WARRANTY/ CONSUMER GUARANTEES

### **UK Customers:**

Read our complete warranty policy online at [leapfrog.com/warranty](http://leapfrog.com/warranty).

### **Australian Customers:**

VTECH ELECTRONICS (AUSTRALIA) PTY LIMITED –  
CONSUMER GUARANTEES

Under the Australian Consumer Law, a number of consumer guarantees apply to goods and services supplied by VTech Electronics (Australia) Pty Limited. Please refer to [leapfrog.com/en-au/legal/warranty](http://leapfrog.com/en-au/legal/warranty) for further information.



CLASS 1  
LED PRODUCT



***Visit our website for more  
information about our products,  
downloads, resources and more.***

***leapfrog.com  
leapfrog.com.au***

LeapFrog Enterprises, Inc.  
A subsidiary of VTech Holdings Limited.  
TM & © 2020 LeapFrog Enterprises, Inc.  
All rights reserved.  
91-003830-001 