

nickelodeon



## Handy Dandy Clue Tracker



### Parents' Guide

This guide contains important information.  
Please keep it for future reference.

91-003918-000 US

# INTRODUCTION

Thank you for purchasing the **LeapBuilders® Blue's Clues & You!™ Handy Dandy Clue Tracker**.

Play Blue's Clues with the interactive Smart Star™ unit shaped like the Handy Dandy Notebook from the show *Blue's Clues & You!*™. Help Josh by finding learning blocks with the correct pictures and putting them in the Smart Star™ Clue Tracker. Then, practice critical thinking and logic skills to help Josh solve Blue's Clues.

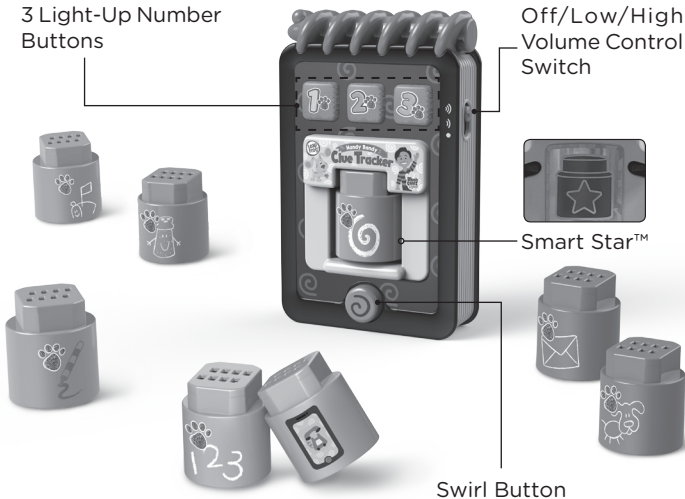

# INCLUDED IN THIS PACKAGE

LeapBuilders® *Blue's Clues & You!*™ Handy Dandy Clue Tracker



- 8 double-sided learning blocks

Front



Back



- 1 parents' guide

## WARNING

All packing materials such as tape, plastic sheets, packaging locks, removable tags, cable ties, cords and packaging screws are not part of this toy, and should be discarded for your child's safety.

## NOTE

Please keep this parents' guide as it contains important information.

## ATTENTION

Pour la sécurité de votre enfant, débarrassez-vous de tous les produits d'emballage tels que rubans adhésifs, feuilles de plastique, attaches, étiquettes, cordons et vis d'emballage. Ils ne font pas partie du jouet.

## NOTE

Il est conseillé de conserver ce guide des parents car il comporte des informations importantes.

# GETTING STARTED

## Battery Removal and Installation

1. Make sure the unit is turned **Off**.
2. Find the battery cover located on the bottom of the unit, use a screwdriver or coin to loosen the screw and then open the battery cover.
3. Remove old batteries by pulling up on one end of each battery.
4. Install 2 new AAA (AM-4/LR03) batteries following the diagram inside the battery cover.
5. Replace the battery cover and tighten the screw to secure.

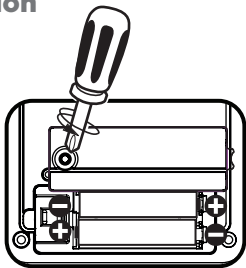

## BATTERY NOTICE

- Use new alkaline batteries for maximum performance.
- Use only batteries of the same or equivalent type as recommended.
- Do not mix different types of batteries: alkaline, standard (carbon-zinc), rechargeable, or new and used batteries.
- Do not use damaged batteries.
- Insert batteries with the correct polarity (+ and -).
- Do not short-circuit the battery terminals.
- Remove exhausted batteries from the toy.
- Remove batteries during long periods of non-use.
- Do not dispose of batteries in fire.
- Do not charge non-rechargeable batteries.
- Remove rechargeable batteries from the toy before charging (if removable).
- Rechargeable batteries are only to be charged under adult supervision.



### WARNING/ATTENTION

Adult assembly required for battery installation.

Keep batteries out of reach of children.

Ce jouet doit être assemblé par un adulte.

Les piles ou accumulateurs doivent être installés par un adulte.

Tenir les piles ou accumulateurs hors de portée des enfants.

### Unlock the Packaging Lock

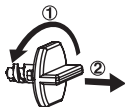

- ① Rotate the packaging lock 90 degrees counterclockwise.
- ② Pull out the packaging lock and discard.

# PRODUCT FEATURES

## 1. Off/Low/High Volume Switch

To turn the unit **On**, slide the **Off/Low/High Volume Control Switch** to the **Low Volume** ( ) or **High Volume** ( )) position. To turn the unit **Off**, slide the **Off/Low/High Volume Control Switch** to the **Off** ● position.

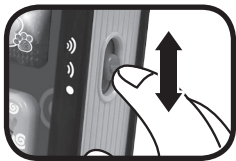

## 2. Three Light-Up Number Buttons

Press the **Light-Up Number Buttons** to learn about numbers and play Blue's Clues.



## 3. Swirl Button

Press the **Swirl Button** to release the **Learning Blocks** from the **Smart Star**™ and play fun phrases or sounds.

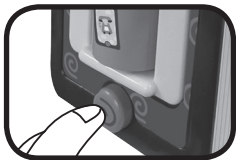

## 4. Automatic Shut Off

To preserve battery life, the **LeapBuilders® Blue's Clues & You!™ Handy Dandy Clue Tracker** will automatically shut off after approximately 80 seconds without input. The unit can be turned on again by pressing any button or by inserting a **Learning Block** into the **Smart Star**™.

**NOTE:** This product is in try-me mode in the packaging. After opening the package, turn the product off and on again to proceed with normal play. If the unit powers down while playing, please install a new set of batteries.

# ACTIVITIES

## 1. Light-Up Number Buttons

Press the **Light-Up Number Buttons** to learn about numbers and play Blue's Clues. The lights will flash with the sounds.



## 2. Blue's Clues

Press a **Light-Up Number Button** and Josh will ask you to find a clue block. Pick up a **Learning Block** with the correct picture and insert it into the **Smart Star™**. Find all three clues to solve Blue's Clues.

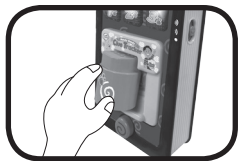

## 3. Swirl Button

Press the **Swirl Button** to hear fun phrases and sounds and to release **Learning Blocks** from the **Smart Star™**. If the clue game is activated, it will ask you to find the next clue. The lights will flash with the sounds.



## 4. Learning Blocks

Insert the **Double-Sided Learning Blocks** into the interactive **Smart Star™ Cube** to learn about objects, vocabulary words and different clues. Then, play Blue's Clues with Blue and Josh. The lights will flash with the sounds.



## 5. Mix and Match

For added fun, the **LeapBuilders® Blue's Clues & You!™ Handy Dandy Clue Tracker** interacts with the **Learning Blocks** from other LeapBuilders® sets. Simply put a **Learning Block** from another LeapBuilders® set into the **Smart Star™ Cube** to see flashing lights and hear learning phrases and short tunes (additional sets sold separately). Please note, blocks from sets in a different language have unique audio responses and cannot be used interchangeably.

## SING-ALONG SONG LYRICS

### Song 1

Learning is so fun to do,  
Numbers, letters, colors, clues!  
Come on let's go figure it out,  
With Blue and you!

## CARE & MAINTENANCE

1. Keep the unit clean by wiping it with a slightly damp cloth.
2. Keep the unit out of direct sunlight and away from any direct heat source.
3. Remove the batteries when the unit will not be in use for an extended period of time.
4. Do not drop the unit on hard surfaces and do not expose the unit to moisture or water.



# TROUBLESHOOTING

If for some reason the unit stops working or malfunctions, please follow these steps:

1. Please turn the unit **OFF**.
2. Interrupt the power supply by removing the batteries.
3. Let the unit stand for a few minutes, then replace the batteries.
4. Turn the unit **ON**. The unit will now be ready to use again.
5. If the unit still does not work, install a brand new set of batteries.

## **IMPORTANT NOTE:**

If the problem persists, please call our Consumer Services Department at **1-800-701-5327** in the U.S. or email [support@leapfrog.com](mailto:support@leapfrog.com). Creating and developing LeapFrog® products is accompanied by a responsibility that we take very seriously. We make every effort to ensure the accuracy of the information, which forms the value of our products. However, errors sometimes can occur. It is important for you to know that we stand behind our products and encourage you to contact us with any problems and/or suggestions you might have. A service representative will be happy to help you.

## Environmental phenomena

The unit may malfunction if subjected to radio-frequency interference. It should revert to normal operation when the interference stops. If not, it may become necessary to turn the power **OFF** and back **ON**, or remove and reinstall the batteries. In the unlikely event of an electrostatic discharge, the unit may malfunction and lose memory, requiring the user to reset the device by removing and reinstalling the batteries.

## Impact de l'environnement

Une défaillance de fonctionnement de l'appareil peut survenir s'il est sujet à des interférences avec les fréquences radioélectriques. Le fonctionnement normal de l'appareil devrait reprendre avec l'arrêt des interférences. Si ce n'est pas le cas, il peut s'avérer nécessaire d'éteindre et rallumer l'appareil ou de retirer et réinstaller les piles. Dans l'éventualité peu probable d'une décharge électrostatique, un mauvais fonctionnement et une perte de mémoire de l'appareil peuvent se produire. L'utilisateur doit alors retirer et réinstaller les piles pour réinitialiser l'appareil.

## NOTE:

This equipment has been tested and found to comply with the limits for a Class B digital device, pursuant to Part 15 of the FCC Rules. These limits are designed to provide reasonable protection against harmful interference in a residential installation. This equipment generates, uses and can radiate radio frequency energy and, if not installed and used in accordance with the instructions, may cause harmful interference to radio communications. However, there is no guarantee that interference will not occur in a particular installation. If this equipment does cause harmful interference to radio or television reception, which can be determined by turning the equipment off and on, the user is encouraged to try to correct the interference by one or more of the following measures:

- Reorient or relocate the receiving antenna.
- Increase the separation between the equipment and receiver.
- Connect the equipment into an outlet on a circuit different from that to which the receiver is connected.
- Consult the dealer or an experienced radio/TV technician for help.

**Caution:** Changes or modifications not expressly approved by the party responsible for compliance could void the user's authority to operate the equipment.

### Supplier's Declaration of Conformity

47 CFR § 2.1077 Compliance Information

Trade Name:	LeapFrog®
Model:	6126
Product Name:	LeapBuilders® <i>Blue's Clues &amp; You!</i> ™ Handy Dandy Clue Tracker
Responsible Party:	LeapFrog Enterprises, Inc.
Address:	6401 Hollis Street, Suite 100, Emeryville, CA 94608
Website:	leapfrog.com



***Visit our website for more  
information about our products,  
downloads, resources and more.***

***leapfrog.com***

***Read our complete warranty policy online at  
leapfrog.com/warranty.***

© 2020 Viacom International Inc.  
All Rights Reserved. Nickelodeon,  
*Blue's Clues & You!* and all related  
titles, logos and characters  
are trademarks of Viacom  
International Inc.

LeapFrog Enterprises, Inc., A  
subsidiary of VTech Holdings Limited.  
TM & © 2020 LeapFrog Enterprises,  
Inc. All rights reserved.

91-003918-000 (US)