

nickelodeon



# ABC Discovery Board



## Parents' Guide

This guide contains important information.  
Please keep it for future reference.

91-003974-000 USCA

# INTRODUCTION

Thank you for purchasing the ***Blue's Clues & You!***™ ABC Discovery Board!

As your child explores the letter buttons with Blue and Josh, they will learn about letters, the sounds these letters make, and words that start with these letters. Activities also build early spelling skills and foster creativity.

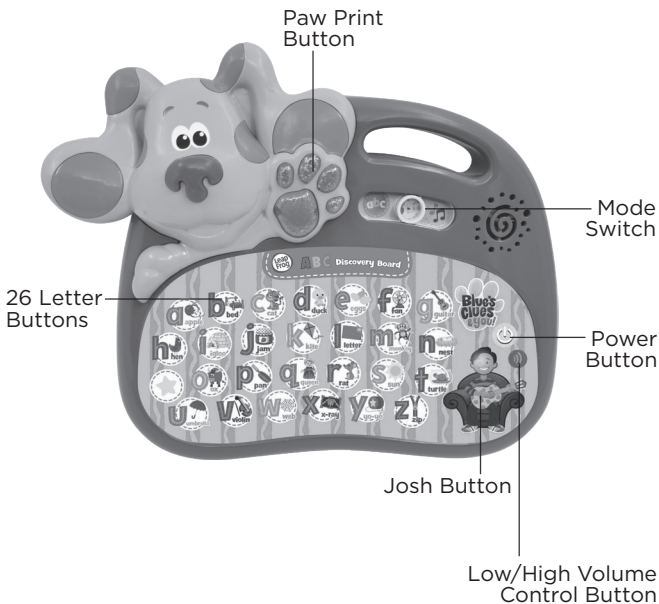

# INCLUDED IN THIS PACKAGE

## *Blue's Clues & You!*<sup>TM</sup> ABC Discovery Board

- Parents' guide

### **WARNING**

All packing materials such as tape, plastic sheets, packaging locks, removable tags, cable ties and packaging screws are not part of this toy, and should be discarded for your child's safety.

### **NOTE**

Please keep this parents' guide as it contains important information.

### **ATTENTION**

Pour la sécurité de votre enfant, débarrassez-vous de tous les produits d'emballage tels que rubans adhésifs, feuilles de plastique, attaches, étiquettes et vis d'emballage. Ils ne font pas partie du jouet.

### **NOTE**

Il est conseillé de conserver ce guide des parents car il comporte des informations importantes.

### **Unlock the Packaging Locks**

- ① Rotate the packaging locks 90 degrees counterclockwise.
- ② Pull out the packaging lock and discard.

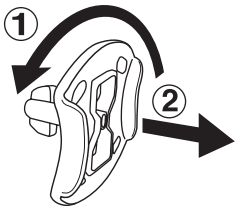

# GETTING STARTED

## Battery Removal and Installation

1. Make sure the unit is turned **Off**.
2. Find the battery cover located on the back of the unit, use a coin or screwdriver to loosen the screw and then open the battery cover.
3. Remove old batteries by pulling up on one end of each battery.
4. Install 3 new AA (AM-3/LR6) batteries following the diagram inside the battery cover. (The use of new alkaline batteries is recommended for maximum performance.)
5. Replace the battery cover and tighten the screw to secure.

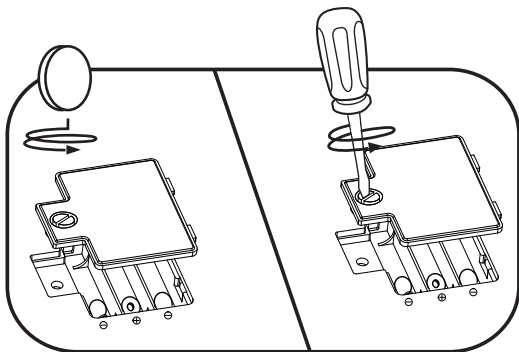



## **WARNING:**

Adult assembly required for battery installation.  
Keep batteries out of reach of children.



## **ATTENTION :**

Les piles ou accumulateurs doivent être installés par un adulte. Tenir les piles ou accumulateurs hors de portée des enfants.

## **IMPORTANT: BATTERY INFORMATION**

- Insert batteries with the correct polarity (+ and -).
- Do not mix old and new batteries.
- Do not mix alkaline, standard (carbon-zinc) or rechargeable batteries.
- Only batteries of the same or equivalent type as recommended are to be used.
- Do not short-circuit the supply terminals.
- Remove batteries during long periods of non-use.
- Remove exhausted batteries from the toy.
- Dispose of batteries safely. Do not dispose of batteries in fire.

## **RECHARGEABLE BATTERIES**

- Remove rechargeable batteries from the toy before charging.
- Rechargeable batteries are only to be charged under adult supervision.
- Do not charge non-rechargeable batteries.

# PRODUCT FEATURES

## 1. Power Button

To turn the unit **On**, press the **Power Button**. To turn the unit **Off**, press the **Power Button**.



## 2. Low/High Volume Control Button

Press the **Low/High Volume Control Button** to raise or lower the volume.



## 3. Mode Switch

Move the switch to any position to play one of three modes: Letters and Sounds, Words and Letters, or Music.



## 4. Letter Buttons

Press the **Letter Buttons** to hear letters and letter sounds.



## 5. Light-Up Paw Print Button

Press the **Paw Print Button** to play a search-and-find game, find answers with Blue, or sing the ABCs with Josh.



## 6. Light-Up Josh Button

Press the **Josh Button** to make a silly song with letter sounds or sing a spelling song.



# ACTIVITIES

## 1. Letters and Sounds

Press the **Letter Buttons** to learn letters and letter sounds. Press the **Paw Print Button** to test letter and phonics skills. Press the **Josh Button** to make a silly song with letter sounds.

## 2. Words & Letters

Press the **Letter Buttons** to learn words. Press the **Paw Print Button** to find answers to questions and spell with Josh. Press the **Josh Button** to sing spelling songs with Josh.

## 3. Music

Press the **Letter Buttons** to play the notes of the ABC Song. Press the **Paw Print Button** to help Josh sing the ABCs. Press the **Josh Button** to sing along with Josh.

## **SING & SPELL**

The letter C comes at the start.  
It says /k/. Now the second part,  
The letter A is next in line.  
It says /a/. That sure is fine.  
The letter T it comes third.  
It says /t/. Now we have a word!  
/k/ /a/ /t/. Cat.

## **ABC SONG**

A B C D E F G,  
H I J K L M N O,  
Then comes P,  
Q R S T U V,  
W X Y and Z,  
Now I know my ABCs,  
Next time won't you sing with me.



# CARE & MAINTENANCE

1. Keep the unit clean by wiping it with a slightly damp cloth.
2. Keep the unit out of direct sunlight and away from any direct heat sources.
3. Remove the batteries if the unit will not be in use for an extended period of time.
4. Do not drop the unit on hard surfaces and do not expose the unit to moisture or water.

# TROUBLESHOOTING

If for some reason the unit stops working or malfunctions, please follow these steps:

1. Turn the unit **Off**.
2. Interrupt the power supply by removing the batteries.
3. Let the unit stand for a few minutes, then replace the batteries.
4. Turn the unit **On**. The unit should now be ready to use again.
5. If the unit still does not work, install a new set of batteries.

## IMPORTANT NOTE:

If the problem persists, please call our **Consumer Services Department** at **1-800-701-5327** in the U.S. and Canada, or email **support@leapfrog.com**. Creating and developing LeapFrog products is accompanied by a responsibility that we take very seriously. We make every effort to ensure the accuracy of the information, which forms the value of our products. However, errors sometimes can occur. It is important for you to know that we stand behind our products and encourage you to contact us with any problems and/or suggestions you might have. A service representative will be happy to help you.

## Environmental Phenomena

The unit may malfunction if subjected to radio-frequency interference. It should revert to normal operation when the interference stops. If not, it may become necessary to turn the power **Off** and back **On**, to remove and reinstall the batteries. In the unlikely event of an electrostatic discharge, the unit may malfunction and lose memory, requiring the user to reset the device by removing and reinstalling the batteries.

### NOTE

This equipment has been tested and found to comply with the limits for a Class B digital device, pursuant to Part 15 of the FCC Rules. These limits are designed to provide reasonable protection against harmful interference in a residential installation. This equipment generates, uses and can radiate radio frequency energy and, if not installed and used in accordance with the instructions, may cause harmful interference to radio communications. However, there is no guarantee that interference will not occur in a particular installation. If this equipment does cause harmful interference to radio or television reception, which can be determined by turning the equipment off and on, the user is encouraged to try to correct the interference by one or more of the following measures:

- Reorient or relocate the receiving antenna.
- Increase the separation between the equipment and receiver.
- Connect the equipment into an outlet on a circuit different from that to which the receiver is connected.
- Consult the dealer or an experienced radio/TV technician for help.

### CAUTION

Changes or modifications not expressly approved by the party responsible for compliance could void the user's authority to operate the equipment.

## Impact de l'environnement

Une défaillance de fonctionnement de l'appareil peut survenir s'il est sujet à des interférences avec les fréquences radioélectriques. Le fonctionnement normal de l'appareil devrait reprendre avec l'arrêt des interférences. Si ce n'est pas le cas, il peut s'avérer nécessaire d'éteindre et rallumer l'appareil ou de retirer et réinstaller les piles. Dans l'éventualité peu probable d'une décharge électrostatique, un mauvais fonctionnement et une perte de mémoire de l'appareil peuvent se produire. L'utilisateur doit alors retirer et réinstaller les piles pour réinitialiser l'appareil.

### Supplier's Declaration of Conformity

47 CFR § 2.1077 Compliance Information

Trade Name:	LeapFrog®
Model:	6139
Product Name:	<i>Blue's Clues &amp; You!</i> ™ ABC Discovery Board
Responsible Party:	LeapFrog Enterprises, Inc.
Address:	2200 Powell Street, Suite 500 Emeryville, California 94608
Website:	leapfrog.com

THIS DEVICE COMPLIES WITH PART 15 OF THE FCC RULES. OPERATION IS SUBJECT TO THE FOLLOWING TWO CONDITIONS: (1) THIS DEVICE MAY NOT CAUSE HARMFUL INTERFERENCE, AND (2) THIS DEVICE MUST ACCEPT ANY INTERFERENCE RECEIVED, INCLUDING INTERFERENCE THAT MAY CAUSE UNDESIRE OPERATION.

**CAN ICES-003 (B)/NMB-003(B)**



**Visit our website for more  
information about our products,  
downloads, resources and more.**

***leapfrog.com***  
***leapfrog.ca***

**Read our complete warranty policy online at  
*leapfrog.com/legal***

© 2021 Viacom International Inc.  
All Rights Reserved. Nickelodeon, Blue's  
Clues & You! and all related titles,  
logos and characters are trademarks  
of Viacom International Inc.

LeapFrog Enterprises, Inc.,  
A subsidiary of VTech Holdings Limited.  
TM & © 2021 LeapFrog Enterprises, Inc.

All rights reserved.  
91-003974-000 US CA