



Sleep & Wake Storyteller™



Instruction Manual

This Manual contains important information. Please keep it for future reference.

INTRODUCTION

Thank you for purchasing **Sleep & Wake Storyteller™**! Your child's bedtime companion with soothing sleep and wake lights, 80+ songs, stories, nature sounds and more!

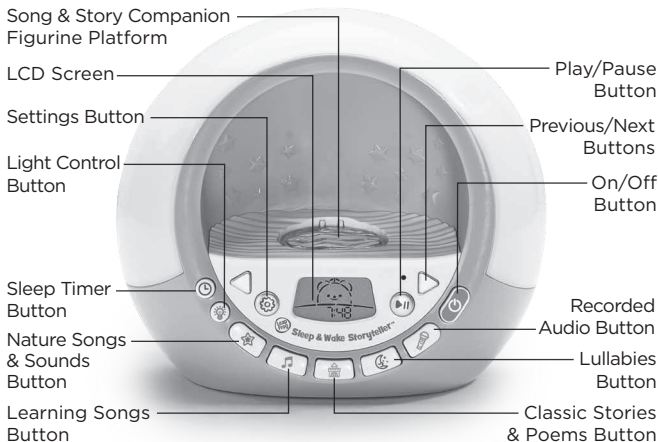

Classic Stories
& Poems
Figurine



Lullabies
Figurine



Learning
Songs
Figurine





Record Switch

Volume Dial

USB Type-C®
Power Port

Power Switch

USB Type-C®
Power Cable



INCLUDED IN THIS PACKAGE

- **Sleep & Wake Storyteller™**
- Three **Song & Story Companion Figurines**
- USB Type-C® cable
- Quick Start Guide

WARNING

All packing materials such as tape, plastic sheets, packaging locks, removable tags, cable ties, cords and packaging screws are not part of this toy, and should be discarded for your child's safety.

NOTE

Please save this Instruction Manual as it contains important information.

ATTENTION

Pour la sécurité de votre enfant, débarrassez-vous de tous les produits d'emballage tels que rubans adhésifs, feuilles de plastique, attaches, étiquettes, cordons et vis d'emballage. Ils ne font pas partie du jouet.

NOTE

Il est conseillé de conserver ce guide de démarrage rapide car il comporte des informations importantes.

GETTING STARTED

Battery Removal and Installation

1. Make sure the unit is turned **Off**.
2. Find the battery cover located on the back of the unit, use a screwdriver to loosen the screw and then open the battery cover.
3. Remove old batteries by pulling up on one end of each battery.
4. Install 4 new AA (AM-3/LR6) batteries following the diagram inside the battery box. (For best performance, alkaline batteries or fully charged Ni-MH rechargeable batteries are recommended.)
5. Replace the battery cover and tighten the screw to secure.

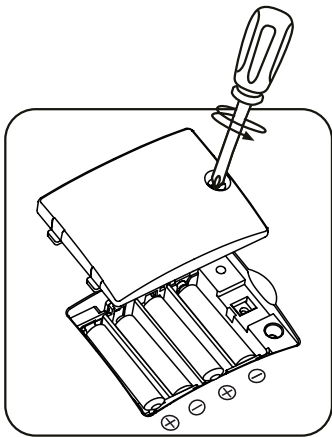



WARNING:

Adult assembly required for battery installation.
Keep batteries out of reach of children.



ATTENTION :

Les piles ou accumulateurs doivent être installés par un adulte. Tenir les piles ou accumulateurs hors de portée des enfants.

IMPORTANT: BATTERY INFORMATION

- Insert batteries with the correct polarity (+ and -).
- Do not mix old and new batteries.
- Do not mix alkaline, standard (carbon-zinc) or rechargeable batteries.
- Only batteries of the same or equivalent type as recommended are to be used.
- Do not short-circuit the supply terminals.
- Remove batteries during long periods of non-use.
- Remove exhausted batteries from the toy.
- Dispose of batteries safely. Do not dispose of batteries in fire.

RECHARGEABLE BATTERIES

- Remove rechargeable batteries (if removable) from toy before charging.
- Rechargeable batteries are only to be charged under adult supervision.
- Do not charge non-rechargeable batteries.

SAFETY INFORMATION

Safety information when using power supply for toys

Note: The USB charger or AC/DC adapter is referred to as “power supply” throughout the manual.

LeapFrog recommends a power supply of the below specification:

USB port for power supply:

The power input to USB port is DC $\overline{\text{---}}$ 5V, with a minimum of 0.5A.

- If using a USB charger or AC/DC adapter, this toy should only be used with a power supply suitable for use with toys.
- The power supply is not a toy.
- This toy is not intended for use by children under 3 years old.
- Do not connect the toy to more than the recommended number of power supplies.
- Never clean a plugged in toy with liquid.
- Please examine the power supply periodically for conditions that may result in the risk of fire, electric shock, or injury to persons (such as damage to the supply cord, output cord, plug, blades, housing, or other parts) and that, in the event of such conditions, the power supply should be scrapped.
- Power supplies for toys are not intended to be used as toys, and the use of these products by children shall be under the full supervision of parents.

Unplug the USB cable or the AC adapter if any of the following conditions exist:

- The AC adapter, plug or USB cable has become frayed or damaged.
- The AC adapter, plug or USB cable has been exposed to rain, liquid or excessive moisture.
- The enclosure of the AC adapter, plug or USB cable has become damaged.
- You suspect the AC adapter, plug or USB cable needs service or repair.

Cleaning

Disconnect all cords before cleaning. Clean the product with a slightly damp cloth (cold water). Do not use soap, detergent or other chemicals. Never submerge the unit in water. Allow to dry thoroughly before re-use.

Do not connect to any power supply if wet or damaged.

PRODUCT FEATURES

1. Power Switch

Slide the **Power Switch** to the **ON** position and then press the **ON/OFF Button** on the front of the device to power the toy **ON** or **OFF**. The time and alarms will be reset each time the **Power Switch** is moved to the **OFF** position. Slide the **Power Switch** to the **OFF** position if you will not use this toy for a long time.

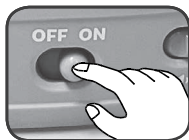

2. Volume Dial

Slide the **Volume Dial** left or right to adjust the volume level.



3. USB Port

To power the device using the USB Power Cable, insert the end of the cable into the **USB Type-C® Port**.

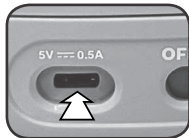

4. Record Switch

Slide the switch on the back of the device to record your own story, up to 10 minutes long. The newly recorded story will overwrite any previously recorded audio. To play your recorded story, press the **Recorded Audio Button** on the front of the device.



5. On/Off Button

Press the **On/Off Button** on the front of the device to put it in power-saving mode. The LCD display will remain **On** during power-saving mode. Press the **On/Off Button** again to exit power-saving mode. Use the **Power Switch** on the back of the device to turn it completely off.

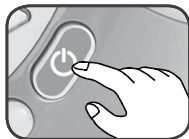

6. LCD Screen

The **LCD Screen** displays the clock.



7. Light Control Button

This device displays soothing lights on its top and on the **Song & Story Companion Figurine Platform**. Press this button to turn one or both sets of lights **On/Off**.

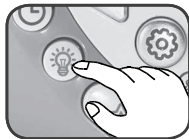

8. Settings Button

Hold the button for 3 seconds to adjust the following settings:

- Clock time
- Bedtime and Wake-Up Time
- Nap Time and Wake-Up Time
- Alarm **On/Off**

Press the **Settings Button** to cycle through the options. Use the **Previous/Next Arrows** to adjust the setting and **Play/Pause** to confirm it.

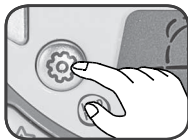

9. Sleep Timer Button

Press the button to activate soothing songs and lights to help your child relax. First, press the button one, two, or three times to set the time duration to 15, 30, or 45 minutes. (Press it a fourth time to turn the feature **Off**.) Then, select a playlist by pressing a category button or putting a figurine on the pedestal. While the Sleep Timer is on, the device will play songs or stories in the currently selected category. When the timer is up, the device will go into power-saving mode.

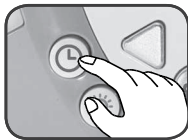

10. Nature Songs & Sounds Button

This button plays soothing nature sounds and nature-inspired songs.



11. Learning Songs Button

This button plays a variety of fun learning songs.



12. Classic Stories & Poems Button

Press this button to hear classic poems and entertaining stories.



13. Lullabies Button

Press this to hear calming lullabies.



14. Recorded Audio Button

Press this to play back the audio you've recorded with the **Record Switch**.

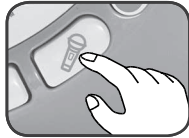

15. Play/Pause Button

Press this to start or pause the audio.



16. Previous/Next Buttons

Use these buttons to play the previous or next audio item in the category you've selected.

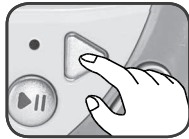

17. Song & Story Companion Figurine Platform

Put one of the **Song & Story Companion Figurine** on the platform to change the playlist.

- The **Bird** plays **Learning Songs**
- The **Bear** plays **Classic Songs & Poems**
- The **Koala** plays **Lullabies**



18. Automatic Shut Off

To save power, the device will automatically enter power-saving mode after about 50 seconds if a story or song is not playing. To save batteries, it's recommended to plug the **Sleep & Wake Storyteller™** device into a USB power supply (not included) using the **USB Type-C® Cable**.

19. Night Light

A soothing night light will turn on at bedtime, nap time, and when the sleep timer is activated.

If the toy is externally powered, the night light will remain on for the entire duration. Otherwise, it will turn off after ten minutes to conserve power.

ACTIVITIES

Listen to a Story, Poem or Song

Press a category button or place a **Song & Story Companion Figurine** on the platform to choose a category. Then press the **Previous/Next Buttons** to cycle through the playlist. Songs and stories will play automatically after their titles are announced.

Included Stories, Poems and Songs

Nature Songs & Sounds

1. Earth's Song
2. Rainfall in the Forest
3. Ocean Waves - Music of the Sea
4. Desert Sunset
5. Gentle Storm
6. Nature Ambience
7. Ocean Waves
8. Ocean Dreams

Learning Songs

1. The Days of the Week
2. On the Farm We Can Play
3. 10 Grapes
4. Five Little Birdies
5. Down By the Bay
6. The Shapes Song
7. Dance-O-Rama Llama
8. Bingo
9. Five Little Monkeys
10. The Wheels On the Bus
11. London Bridge Is Falling Down
12. All the Colors of the Rainbow
13. Every Letter Makes a Sound
14. The Muffin Man
15. Hello around the World
16. Being a Puppy
17. The Weather Song
18. Five Little Speckled Frogs

19. I'm a Little Tea Pot
20. Clean Up
21. Let's Do the Funky Bear
22. Row, Row, Row Your Boat
23. Scrub That Body!
24. Humpty Dumpty
25. Dance And Wiggle
26. Old MacDonald Had a Farm
27. Patty-Cake, Patty-Cake
28. Counting 1 to 10
29. If You're Happy and You Know It
30. Panda's ABC Song
31. Pretend With Me

Classic Stories and Poems

1. The World of Dinosaurs
2. The Three Little Pigs
3. Goldilocks and the Three Bears
4. Robin Hood and the Golden Arrow
5. The Tortoise and the Hare
6. The Fox and the Crow
7. The Ugly Duckling
8. The Gingerbread Man
9. The Emperor's New Clothes
10. Peter Pan and Wendy
11. The Boy Who Cried Wolf
12. The Midas Touch
13. Cinderella
14. The Little Mermaid
15. The Grand Old Duke of York

16. The Owl and the Pussycat
17. The Itsy Bitsy Spider
18. Jack and Jill
19. Jack Be Nimble
20. A Wise Old Owl
21. Round and Round the Garden
22. The Elves and the Shoemaker
23. Hansel and Gretel
24. Jack and the Beanstalk
25. The Tale of Peter Rabbit

Lullabies

1. Twinkle, Twinkle, Little Star
2. Good Night, My Sleepy Friend
3. Calming Music Meditation
4. Quiet Time
5. Brahms's Lullaby
6. Frère Jacques
7. Hush Little Baby
8. Pachelbel's Canon in D
9. Beethoven's Ode to Joy
10. Bach's Minuet in G Major
11. Vivaldi's Spring
12. Rock-a-bye Baby
13. It's Bedtime Solar System
14. Moonlight Music Meditation
15. Owl Helps Bunny Fall Asleep
16. Animals Round the World Go to Sleep at Night
17. Star Light, Star Bright
18. Give Me a Hug

CARE & MAINTENANCE

1. Keep the unit clean by wiping it with a slightly damp cloth.
2. Keep the unit out of direct sunlight and away from any direct heat sources.
3. Remove the batteries if the unit will not be in use for an extended period of time.
4. Do not drop the unit on hard surfaces and do not expose the unit to moisture or water.
5. Examine the **USB Type-C® Cable** regularly, checking for damage to the cable, plugs and other parts. Do not use the **USB Type-C® Cable** if there is any damage.

TROUBLESHOOTING

Check this section if you experience difficulty with operating the **Sleep & Wake Storyteller™** device.

Problem	Possible Cause	Correction
Your Sleep & Wake Storyteller™ device has stopped working or does not turn on	Incorrect battery polarities.	Ensure that the batteries are installed correctly.
	Weak batteries.	Replace with new batteries.
	USB Type-C® Power connection problem.	Ensure that the USB Type-C® cable connection is good.

Environmental Phenomena

The unit may malfunction if subjected to radio-frequency interference. It should revert to normal operation when the interference stops. If not, it may become necessary to turn the power **Off** and back **On**, or remove and reinstall the batteries. In the unlikely event of an electrostatic discharge, the unit may malfunction and lose memory, requiring the user to reset the device by removing and reinstalling the batteries.

Impact de l'environnement

Une défaillance de fonctionnement de l'appareil peut survenir s'il est sujet à des interférences avec les fréquences radioélectriques. Le fonctionnement normal de l'appareil devrait reprendre avec l'arrêt des interférences. Si ce n'est pas le cas, il peut s'avérer nécessaire d'éteindre et rallumer l'appareil ou de retirer et réinstaller les piles. Dans l'éventualité peu probable d'une décharge électrostatique, un mauvais fonctionnement et une perte de mémoire de l'appareil peuvent se produire. L'utilisateur doit alors retirer et réinstaller les piles pour réinitialiser l'appareil.

IMPORTANT NOTE:

If the problem persists, please call our Consumer Services Department at **1-800-701-5327** in the U.S. and Canada, or email support@leapfrog.com. Creating and developing LeapFrog® products is accompanied by a responsibility that we take very seriously. We make every effort to ensure the accuracy of the information, which forms the value of our products. However, errors sometimes can occur. It is important for you to know that we stand behind our products and encourage you to contact us with any problems and/or suggestions you might have. A service representative will be happy to help you.

NOTE

This equipment has been tested and found to comply with the limits for a Class B digital device, pursuant to Part 15 of the FCC Rules. These limits are designed to provide reasonable protection against harmful interference in a residential installation. This equipment generates, uses and can radiate radio frequency energy and, if not installed and used in accordance with the instructions, may cause harmful interference to radio communications. However, there is no guarantee that interference will not occur in a particular installation. If this equipment does cause harmful interference to radio or television reception, which can be determined by turning the equipment off and on, the user is encouraged to try to correct the interference by one or more of the following measures:

- Reorient or relocate the receiving antenna.
- Increase the separation between the equipment and receiver.
- Connect the equipment into an outlet on a circuit different from that to which the receiver is connected.
- Consult the dealer or an experienced radio/TV technician for help.

CAUTION

Changes or modifications not expressly approved by the party responsible for compliance could void the user's authority to operate the equipment.

Supplier's Declaration of Conformity

47 CFR § 2.1077 Compliance Information

Trade Name: LeapFrog®
Model: 6219
Product Name: Sleep & Wake Storyteller™
Responsible Party: LeapFrog Enterprises, Inc.
Address: 2200 Powell St., Suite 500
Emeryville, CA 94608
Website: leapfrog.com

THIS DEVICE COMPLIES WITH PART 15 OF THE FCC RULES. OPERATION IS SUBJECT TO THE FOLLOWING TWO CONDITIONS: (1) THIS DEVICE MAY NOT CAUSE HARMFUL INTERFERENCE, AND (2) THIS DEVICE MUST ACCEPT ANY INTERFERENCE RECEIVED, INCLUDING INTERFERENCE THAT MAY CAUSE UNDESIRE OPERATION.

USB Type-C® Cable: The USB cable provided with this product complies with FCC and other regulatory emission limits. If using a USB cable other than the one provided, please note that in order not to exceed FCC and other regulatory emissions limits, a shielded cable must be used.

USB TYPE-C and USB-C are trademarks of USB Implementers Forum or one of its affiliates.



***Visit our website for more
information about our products,
downloads, resources and more.***

leapfrog.com

***Read our complete warranty
and legal policies online at
leapfrog.com/legal***

A subsidiary of VTech Holdings Limited.
© 2025 LeapFrog Enterprises, Inc.
All rights reserved.
IM-621900-000
Version:0