



## Parent Guide

This guide contains important information.  
Please keep it for future reference.

**Visit our website [leapfrog.com.au](http://leapfrog.com.au) for more information about products, downloads, resources and more.**



**Scan the QR code for more online support:**



Or go to [leapfrog.com.au/support](http://leapfrog.com.au/support)

# Important Safety Instructions

The applied name plate is located at the bottom of the Baby Unit's base. When using your equipment, basic safety precautions should always be followed to reduce the risk of fire, electric shock and injury, including the following:

1. Follow all warnings and instructions marked on the product.
2. Adult setup is required.
3. **CAUTION:** Do not install the Baby Unit at a height above 2 metres.
4. This product is intended as an aid. It is not a substitute for responsible and proper adult supervision and should not be used as such.
5. This product is not intended for use as a medical monitor.
6. Do not use this product near water, for example, near to a bath, sink, swimming pool or shower.
7. **CAUTION:** Use only the battery provided. There may be a risk of explosion if a wrong type of battery is used for the Parent Unit. The battery cannot be subjected to high or low extreme temperature and low air pressure at high altitude during use, storage or transportation. Disposal of battery in fire or a hot oven, mechanically crushing or cutting or the battery can result in an explosion. Leaving the battery in an extremely high temperature surrounding environment can result in an explosion or the leakage of flammable liquid or gas. Battery subjected to extremely low air pressure may result in an explosion or the leakage of flammable liquid or gas. Dispose of used batteries according to the instructions.
8. Use only the adaptors included with this product. Incorrect adaptor polarity or voltage can seriously damage the product.
9. Use only the adaptors and battery listed below.



## Power adaptor information:

VTech Telecommunications Ltd.  
Model : VTO5EAU06040



## Rechargeable battery information:



1. GPI International Limited AAA 930mAh NiMH  
(GNRHCI03C000); 2. YIYANG CORUN BATTERY CO., LTD.  
AAA 950mAh NiMH (Ni-MH AAA950)

10. The power adaptors are intended to be correctly oriented in a vertical or floor mount position. The prongs are not designed to hold the plug in place if it is plugged into a ceiling, under-the-table or cabinet outlet.
11. For pluggable equipment, the socket-outlet shall be installed near the equipment and shall be easily accessible.
12. Unplug this product from the wall outlet before cleaning.
13. Unplug the power cords before replacing batteries.
14. Do not use liquid or aerosol cleaners. Use a damp cloth for cleaning. Do not modify the power adapters or replace with other adaptors.
15. Do not allow anything to rest on the power cords. Do not install this product where the cords may be walked on or crimped.
16. This product should be operated only from the type of power source indicated on the marking label. If you are not sure of the type of power supply in your home, consult your dealer or electricity supply provider.
17. Do not overload wall outlets or use an extension cord.
18. Do not place this product on an unstable table, shelf, stand or other unstable surfaces.

19. This product should not be placed in any area where proper ventilation is not provided. Slots and openings in the back or bottom of this product are provided for ventilation. To protect them from overheating, these openings must not be blocked by placing the product on a soft surface such as a bed, sofa or rug. This product should never be placed near or over a radiator or heat source.
20. Never push objects of any kind into this product through the slots because they may touch dangerous voltage points or create a short circuit. Never spill liquid of any kind on the product.
21. To reduce the risk of electric shock, do not disassemble this product, but take it to an authorised service facility. Disassembling or removing parts of the product other than via the battery door may expose you to dangerous voltages or other risks. Incorrect reassembling can cause electric shock when the product is subsequently used.
22. You should test the sound reception every time you turn on the units or move one of the components.
23. Periodically examine all components for damage.
24. There is a very low risk of privacy loss when using certain electronic devices, such as baby monitors, cordless telephones, etc. **To protect your privacy, make sure the product has never been used before purchase, reset the baby monitor periodically by powering off and then powering on the units, and power off the baby monitor if you are not intending to use it for some time.**
25. Children should be supervised to ensure that they do not play with the product.
26. The small parts of this monitor can be swallowed by babies or small children. Keep these parts out of reach of children.
27. The product is not intended for use by persons (including children) with reduced physical, sensory or mental capabilities, or lack of experience and knowledge, unless they have been given supervision or instruction concerning use of the appliance by a person responsible for their safety.

## SAVE THESE INSTRUCTIONS

### Cautions

1. Use and store the product at a temperature between 0°C and 40°C.
2. Mishandling batteries can cause burn, fire or explosion hazards.
3. Do not expose the product to extreme cold, heat or direct sunlight. Do not place the product close to a heating source.
4. Batteries should not be exposed to excessive heat such as bright sunshine or fire.
5.  Warning—Strangulation Hazard—Children have STRANGLED in cords. Keep this cord out of the reach of children. Do not remove warning label on the adaptor cord. 
6. Never place the Baby Unit(s) inside the baby's cot or playpen. Never cover the Baby Unit(s) or Parent Unit with anything such as a towel or a blanket.
7. Other electronic products may cause interference with your baby monitor. Try installing your baby monitor as far away from these electronic devices as possible: wireless routers, radios, cellular telephones, intercoms, room monitors, televisions, personal computers, kitchen appliances and cordless telephones.

## What's Included

Baby Unit

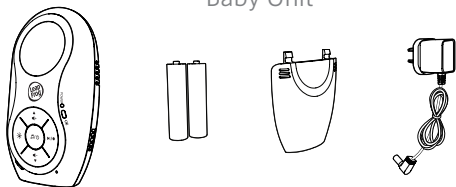

Parent Unit

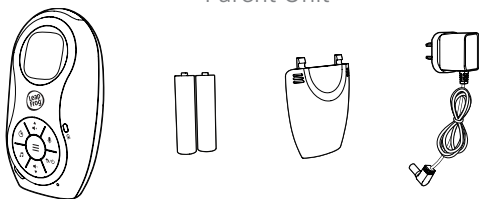

Accessories

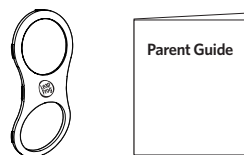

## Connect and Charge the Baby Monitor

### 1. Install Parent Unit Batteries

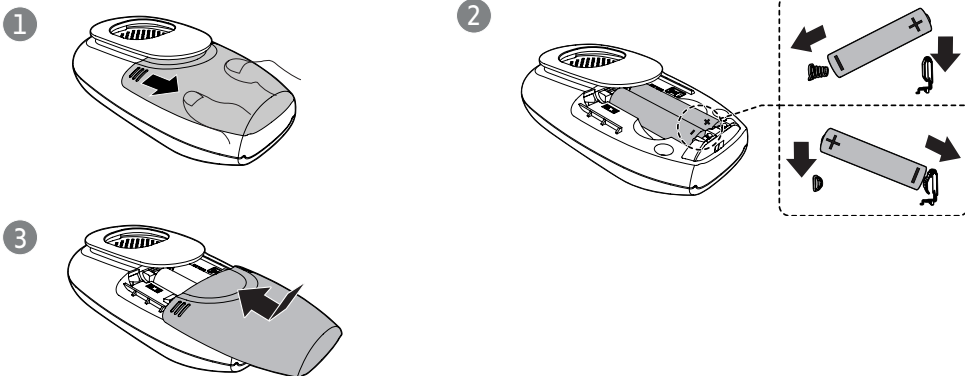

#### Notes:

- Only use and replace batteries with models listed in Important Safety Instructions (9).
- If the Baby Monitor is not intended to be used for long periods, disconnect and remove the batteries to prevent possible leakage.

## 2. Install Baby Unit Batteries

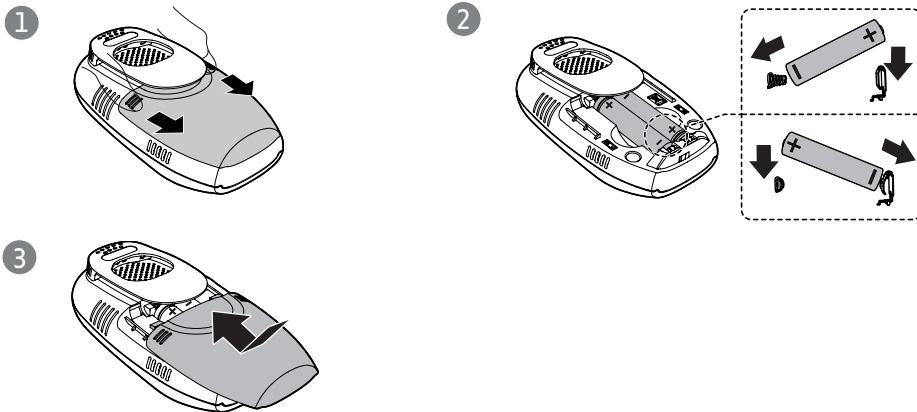

## 3. Connect the Baby Monitor

### Notes:

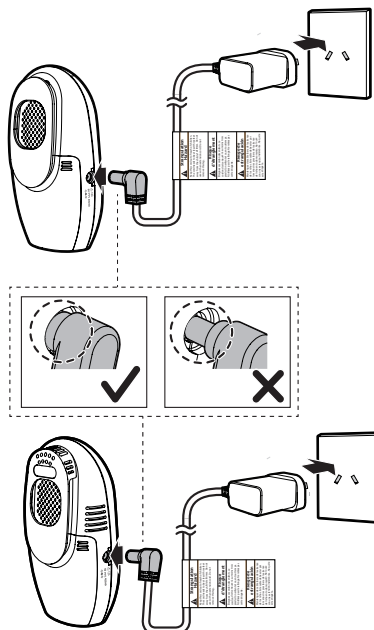

- Use only the power adaptors supplied with this product.
- If your Baby Monitor is connected to a timer controlled socket, make sure it is switched on.
- Connect the power adaptors in a vertical or floor mount position only.
- Make sure Parent Unit, Baby Unit and the power adaptor cords are out of reach of children.



## 4. Charge the Baby Monitor

When you have connected and turned on the Parent Unit and Baby Unit, the batteries will charge automatically.

The battery icon on the screen indicates the battery status:

Battery Indicators	Battery Status	Action
The unit beeps and the screen displays  .	The battery is low in power and may only be used for a short time.	Charge without interruption (about 30 minutes).
The battery icon becomes solid  .	The battery is fully charged.	To keep the battery charged, connect it to AC power when in use.

### Notes:

- Before using the Baby Monitor for the first time, charge the Parent Unit and Baby Unit batteries for 12 hours.
- The standby time varies depending on the sensitivity level you set, your actual usage, and the age of the batteries.

## 5. Power On or Off the Baby Monitor

1. Press and hold  to power on or power off Baby Unit.

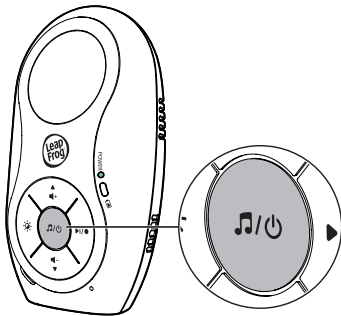

2. Press and hold  to power on or power off Parent Unit.

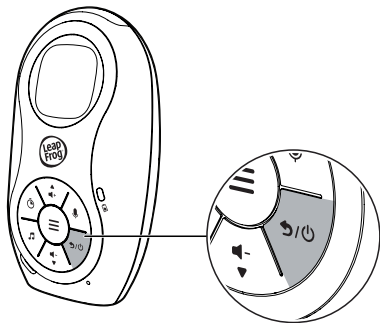

## Position the Baby Monitor

1

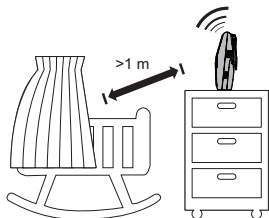

2

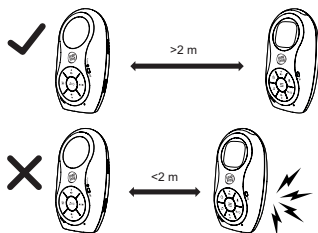

4

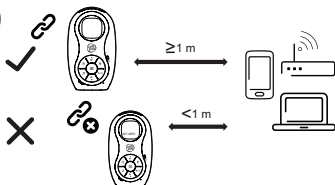

### Caution:

- The default speaker volume of your Parent Unit is level 3. If you experience feedback from your baby monitor while positioning:
  - Make sure your Baby Unit and Parent Unit are more than 2 metres apart, OR
  - Turn down the volume of Parent Unit.

3

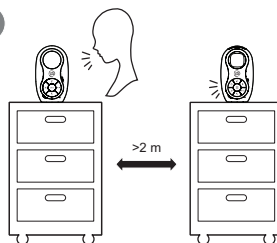

### Notes:

- To avoid interference from other electronic devices, place your baby monitor at least 1 metre away from devices such as wireless routers, microwaves, mobile phones and computers.

## Change the Faceplate

### Detach

1

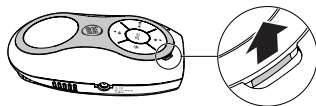

2



3



### Install

1

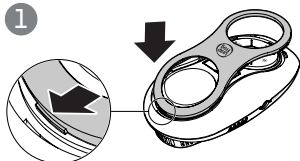

2

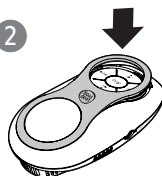

3



# Baby Unit Overview

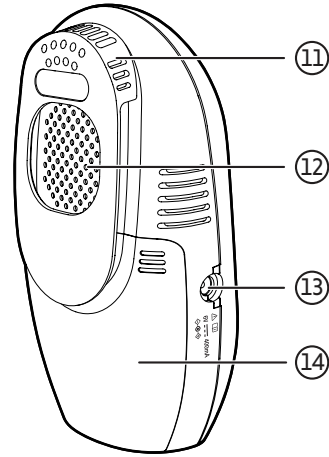
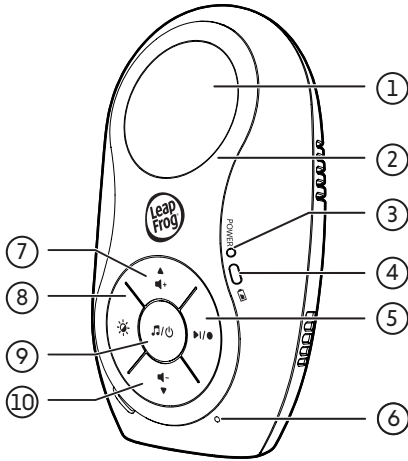

## 1 Night light

- On when night light is turned on manually.
- Off when night light is turned off manually.

## 2 Changeable face plate

## 3 POWER light

- On when Baby Unit is powered on.
- Off when Baby Unit is turned off.

## 4 Battery indication light

- On when Baby Unit's batteries are charging.
- Flashes when the batteries are low and need charging.

## 5

- Press to play the next lullaby.
- Press and hold to record your own voice for up to 20 seconds. Release when finished recording. The recorded voice will be saved as SONG 5.

## 6 Microphone

## 7

- Press to increase the speaker volume (Level 1 to Level 5).

## 8

- Press to turn the night light on or off.
- Press and hold to adjust the brightness of the night light.

## 9

- Press and hold to power on, and the power light turns on.
- Press and hold to power off, and the power light turns off.
- When Baby Unit is powered on, press to play the selected lullaby or the recorded voice. Press again to stop playing.

## 10

- Press to decrease the speaker volume (Level 1 to Level 5).

## 11 Belt clip with temperature sensor

## 12 Speaker

## 13 Power jack

## 14 Battery compartment cover

# Parent Unit Overview

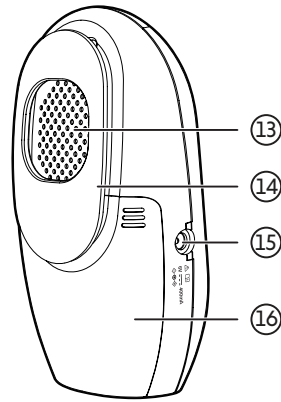
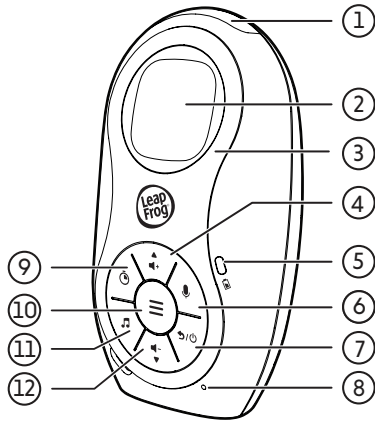

## 1 3- level sound indicator light

- Green when low sound level is detected by Baby Unit.
- Green and amber when moderate sound level is detected by Baby Unit.
- Green, amber and red when high sound level is detected by Baby Unit (e.g. baby crying loudly).

## 2 LCD display

## 3 Changeable face plate



- Press to increase the speaker volume (Level 1 to Level 5).
- While in a menu, press to scroll up.

## 5 Battery indication light

- On when the Parent Unit's batteries are charging.
- Flashes when the batteries are low and need charging.



- Press and hold to talk to your baby.



- Press and hold to power on and power off Parent Unit.
- While in a menu, press to return to the previous menu.

## 8 Microphone



- When in idle mode, press to set the alarm timer.
- When setting the alarm timer, press to exit.



- Press to enter the main menu.
- While in a menu, press to choose an item, or save a setting.
- When setting the alarm timer, press to exit.



- Press to play or stop playing the lullaby or recorded voice.
- When setting the alarm timer, press to reset the timer.



- Press to decrease the speaker volume (Level 1 to Level 5).
- Press repeatedly until the volume reaches the minimum to turn it off.
- While in a menu, press to scroll down.

## 13 Speaker

## 14 Belt clip

## 15 Power jack

## 16 Battery compartment cover



# General Product Care

To keep this product working well and looking good, follow these guidelines:

- Avoid placing it near heating appliances and devices that generate electrical noise (for example, motors or fluorescent lamps).
- DO NOT expose it to direct sunlight or moisture.
- Avoid dropping the product or treating it roughly.
- Clean with a soft damp cloth.
- DO NOT immerse the Parent Unit and the Baby Unit in water and do not clean them under running water.
- DO NOT use cleaning spray or liquid cleaners.
- Make sure the Parent Unit and the Baby Unit are dry before you connect them to the mains again.

## Disposal of Batteries and Product



The crossed-out wheelee bin symbols on products and batteries, or on their respective packaging, indicates they must not be disposed of in domestic waste as they contain substances that can be damaging to the environment and human health.



The chemical symbols Hg, Cd or Pb, where marked, indicate that the battery contains more than the specified value of mercury (Hg), cadmium (Cd) or lead (Pb) set out in Battery Directive (2006/66/EC).

The solid bar indicates that the product was placed on the market after 13th August, 2005.

Help protect the environment by disposing of your product or batteries responsibly.

## Customer Service and Product Warranty

### IMPORTANT

Please retain this booklet with your sales receipt as proof of the date of purchase.

### Customer Service

If you require assistance in operating this product, please call the TechHelp Information Line on 1300 369 193 or contact VTech by e-mail at: [tcpsupport\\_au@vtech.com](mailto:tcpsupport_au@vtech.com).

### Voluntary Product Enquiry

In addition to your Statutory Rights and subject to the conditions below, VTech warrants that this product will be free from any defect in materials or workmanship under conditions of normal use for a period of 24 months from date of purchase.

VTech does not warrant that the product will be free from defects if defects are caused by an accident, misuse, abuse, improper installation or operation, vermin infestations, lack of reasonable care, unauthorised modification, loss of parts, tampering or attempted repair by a person not authorised by VTech; or where the product has been damaged by lightning or a mains power surge. To make a claim under this Voluntary Product Warranty you must call the TechHelp Information Line on 1300 369 193 or contact VTech by e-mail at: [tcpsupport\\_au@vtech.com](mailto:tcpsupport_au@vtech.com) where a Customer Service Representative will inform you of the product return process. You will need to ensure that:

- You provide proof of purchase;
- Your product is suitably packaged (original packaging is not required); and
- You have included all components from the original purchase.

### For your records

Date of purchase:

---

Place of purchase:

---

Serial number:

---

For Voluntary Product Warranty purposes, proof of purchase is required so please keep your receipt.

The benefits conferred by this Voluntary Product Warranty are in addition to other rights and remedies that are available to you under law, which cannot be excluded. The processes for this Voluntary Product Warranty in no way limit your rights which arise as a result of your Statutory Rights.

This Voluntary Product Warranty is given by:

VTech Telecommunications (Australia) Pty Ltd ABN 70 136 672 627

Address: 24 Gilby Road, Mount Waverley 3149

**IMPORTANT NOTE: THIS IS NOT A PRODUCT RETURN OR SERVICE ADDRESS – PLEASE CONTACT TECHHELP BY PHONE OR EMAIL FOR PRODUCT AND WARRANTY SUPPORT. NO LIABILITY WILL BE ACCEPTED BY VTECH FOR PRODUCTS RETURNED TO THIS ADDRESS UNDER THIS VOLUNTARY PRODUCT WARRANTY.**

Phone number: 1300 369 193

Email address: [tcpsupport\\_au@vtech.com](mailto:tcpsupport_au@vtech.com)

### Statutory Rights

Our goods come with guarantees that cannot be excluded under the Australian Consumer Law. You are entitled to a replacement or refund for a major failure and compensation for any other reasonably foreseeable loss or damage. You are also entitled to have the goods repaired or replaced if the goods fail to be of acceptable quality and the failure does not amount to a major failure.

## Customer Support



Find the answer to your questions. Get assisted at your own pace using our knowledge-rich full Online Manual, or contact Customer Support with your inquiries.



**Scan the QR code to access the Online Support Page or visit [leapfrog.com.au/support](https://leapfrog.com.au/support).**

## Technical Specifications

Frequency control	Crystal controlled PLL synthesizer
Transmit frequency	Baby Unit: 1881.792 - 1897.344 MHz Parent Unit: 1881.792 - 1897.344 MHz Maximum power used by the transmitter: 0.25 W (250 mW)
Channels	10
Power requirements	Baby Unit / Parent Unit: 1.2 V AAA 930 / AAA 950 mAh Ni-MH battery Baby Unit / Parent Unit power adaptors: Output: 6 V DC 400 mA



Specifications are subject to change without notice.  
© 2023 LeapFrog Enterprises, Inc.  
a subsidiary of VTech Holdings Limited.  
All rights reserved. 09/23. LF80-X\_AU\_QSG\_V1.